



# Notice of Study Commencement

## Municipal Class Environmental Assessment Study for Bridges 1-P, 28-P, 30-P, 32-P & 33-P

*This notice was first issued on July 20, 2023*

### The Project

The Township of Centre Wellington has initiated a Schedule 'B' Municipal Class Environmental Assessment (MCEA) to evaluate options and select a preferred alternative for five (5) bridge structures (Structures 1-P, 28-P, 30-P, 32-P & 33-P) that are located within a twenty square kilometre (20km<sup>2</sup>) area of road networks located within the former Township of Pilkington. The structures are currently closed to vehicular traffic due to their deteriorated state. This study will evaluate the role of these structures within the overall transportation network and connectivity in the local community and determine the most suitable alternative at each location.

The location of the structures are shown in the key plan herein.

### The Study Process

The Study is being conducted in accordance with Schedule B of the Municipal Class Environmental Assessment (October 2000, as amended) process. This notice signals the commencement of the Municipal Class Environmental Assessment (MCEA) Study. The MCEA Study will confirm and document the existing structural deficiencies and identify alternative solutions, including removal and permanent closure, rehabilitation, or replacement of the structure. The environmental impacts of each alternative will be evaluated and a technically preferred alternative will be selected in consultation with the public, agencies, and Indigenous Communities.

### How to Participate

A key component to this study is public and agency consultation. The public is encouraged to provide input

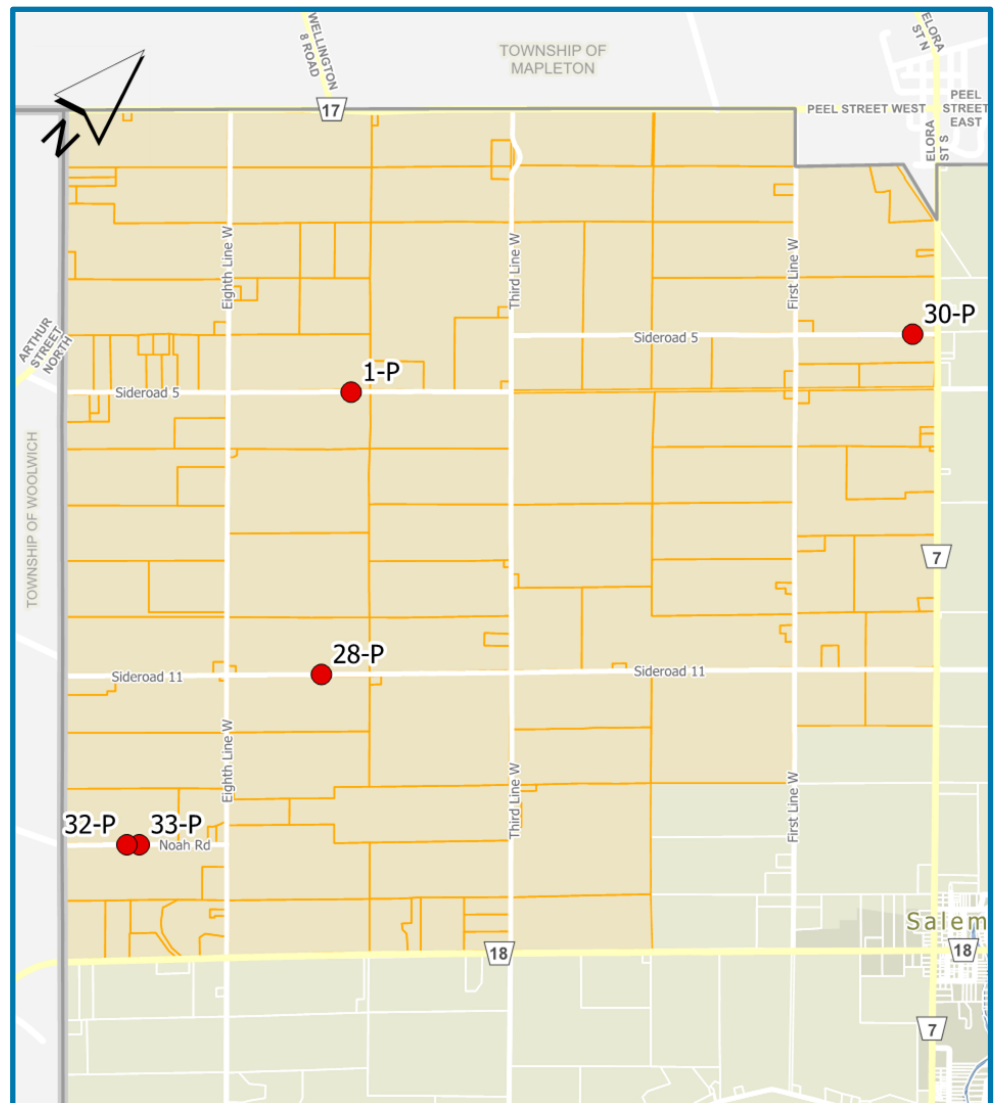

and comments for consideration in developing the preferred alternative. Two in-person Public Open House meetings are planned to occur within the local community as part of this study. The first is planned for mid to late summer of 2023 and will be held to present project information to stakeholders and collect information related to the role of these structures within the local community. Details of the Open House meetings will be provided by mail to affected stakeholders, as well advertised in the **Wellington Advertiser**, **Woolwich Observer** and on **centrewellington.ca** closer to the date under a separate notice.

### **We want to Hear from You!**

If you have any questions or comments regarding the study, or would like to be included on the mailing list to receive future notices and study updates, please contact one of the Project Team members below:

#### **Adam Dickieson**

Engineering Services Coordinator  
Township of Centre Wellington  
1 MacDonald Square, Elora, ON N0B 1S0  
519-846-9691 x 355  
adickieson@centrewellington.ca

#### **Andrew Dawson, P. Eng.**

Consultant Project Manager  
R.J. Burnside & Associates Ltd.  
292 Speedvale Ave W. #20, Guelph, ON N1H 1C4  
705-797-4310  
andrew.dawson@rjburnside.com

Information will be collected in accordance with the *Municipal Freedom of Information and Protection of Privacy Act*. With the exception of personal information, all comments will become part of the public record. If you have accessibility requirements in order to participate in this project, please contact one of the project team members listed above.