

**ZONE CHANGE SKETCH**  
**PART OF LOTS 12 & 13, CONCESSION 5,**  
**EAST OF THE GRAND RIVER**  
**GEOGRAPHIC TOWNSHIP OF PILKINGTON**  
**TOWNSHIP OF CENTRE WELLINGTON**  
**COUNTY OF WELLINGTON**

SCALE 1 : 7000

**KEYMAP**

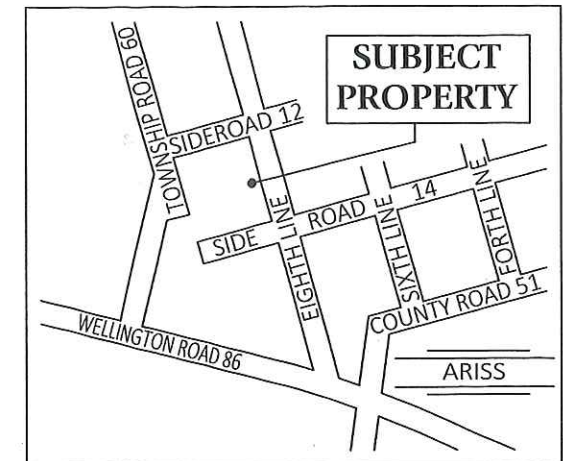

**ZONE CHANGE REQUESTS:**

- (A)** TO REZONE A 0.82ha AREA OF LAND TO A SPECIALIZED AGRICULTURAL TO PERMIT A SCHOOL WITH A MAXIMUM GROUND FLOOR AREA OF 250m<sup>2</sup> IN SECTION 6.1.1 OF THE ZONING BY-LAW.
- (B)** TO PERMIT A REDUCED MDSI SETBACK FROM THE BARN AT #5999 EIGHTH LINE EAST TO THE SCHOOL PARCEL TO BE 340m VS. 461m AS REQUIRED.

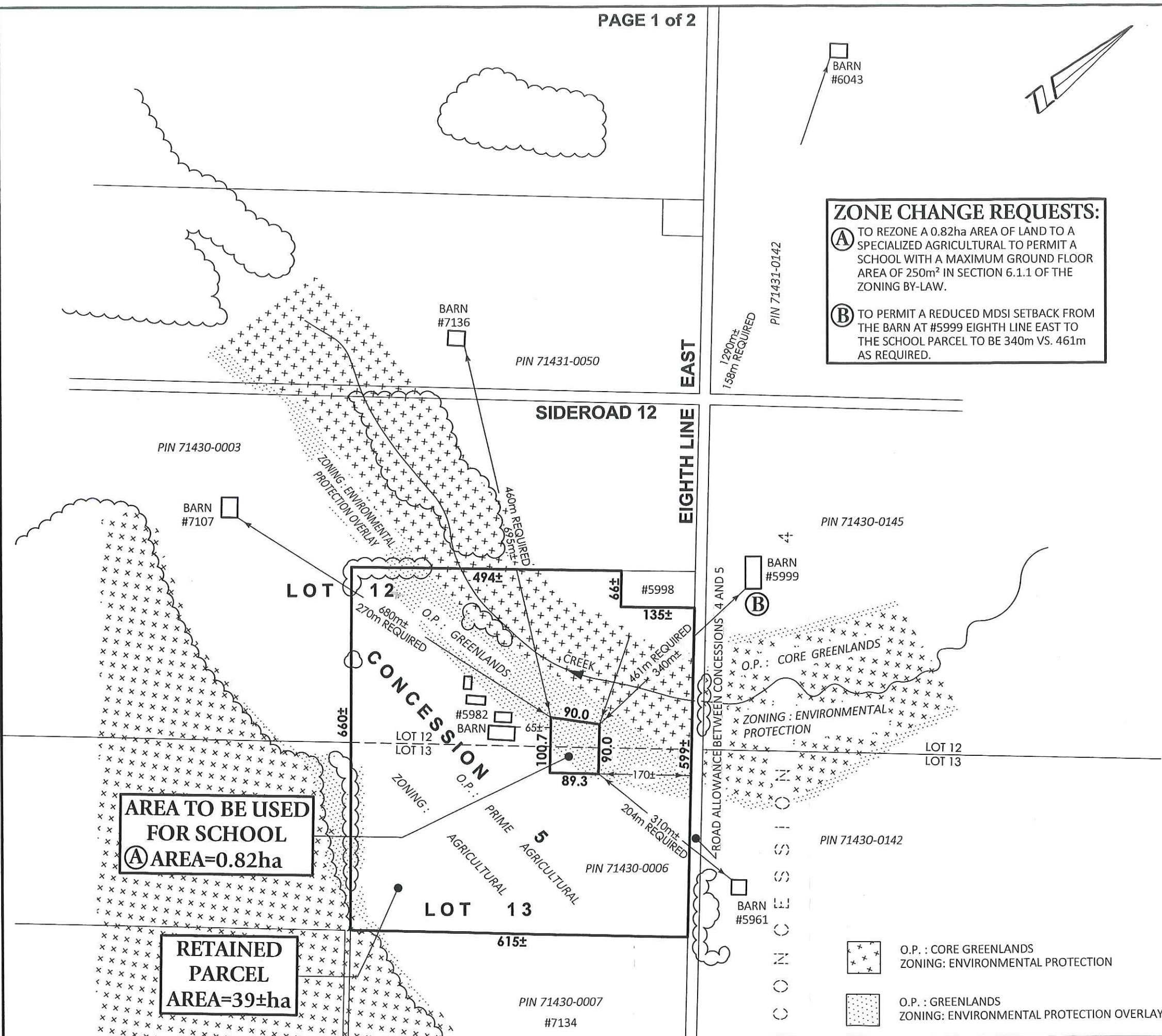

**NOTES:**

1. **THIS IS NOT A PLAN OF SURVEY AND SHOULD NOT BE USED FOR REAL ESTATE TRANSFERS OR MORTGAGES.**
2. SUBJECT LANDS ARE ZONED AGRICULTURAL, ENVIRONMENTAL PROTECTION AND ENVIRONMENTAL PROTECTION OVERLAY.
3. SUBJECT LANDS HAVE AN OFFICIAL PLAN DESIGNATION OF PRIME AGRICULTURAL, GREENLANDS AND CORE GREENLANDS.
4. DISTANCES ON THIS PLAN ARE SHOWN IN METRES AND CAN BE CONVERTED TO FEET BY DIVIDING BY 0.3048.
5. DIMENSIONS ON THIS SKETCH ARE APPROXIMATE AND HAVE NOT BEEN VERIFIED BY SURVEY.
6. PROPERTY OWNERS: NANCY MARTIN & JOSEPH MARTIN.

THIS SKETCH WAS PREPARED ON THE 31st DAY OF MARCH, 2022

*Jeffrey E. Buisman*  
 JEFFREY E. BUISMAN  
 ONTARIO LAND SURVEYOR

**Van Harten**  
 SURVEYING INC.  
 LAND SURVEYORS and ENGINEERS

Kitchener/Waterloo Ph: 519-742-8371	Guelph Ph: 519-821-2763	Orangeville Ph: 519-940-4110
--	----------------------------	---------------------------------

www.vanharten.com info@vanharten.com

DRAWN BY: ARN	CHECKED BY: JEB	PROJECT No. 30641-21
Mar 31, 2022-2:53:48 PM		
G:\PILKINGTON\CON 5 EGR\ACAD\ZONE PLOT 12 13 (VALLEY SCHOOL) UTM.dwg		

- O.P. : CORE GREENLANDS  
ZONING: ENVIRONMENTAL PROTECTION
- O.P. : GREENLANDS  
ZONING: ENVIRONMENTAL PROTECTION OVERLAY

**ZONE CHANGE SKETCH**  
**PART OF LOTS 12 & 13, CONCESSION 5,**  
**EAST OF THE GRAND RIVER**  
**GEOGRAPHIC TOWNSHIP OF PILKINGTON**  
**TOWNSHIP OF CENTRE WELLINGTON**  
**COUNTY OF WELLINGTON**

SCALE 1 : 1500



VAN HARTEN SURVEYING INC.

**KEYMAP**

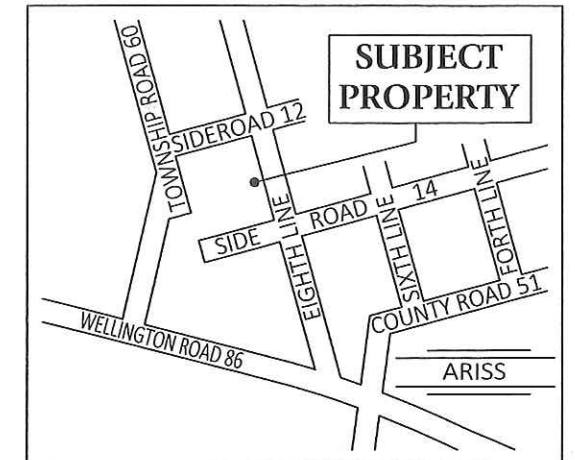

**NOTES:**

1. **THIS IS NOT A PLAN OF SURVEY AND SHOULD NOT BE USED FOR REAL ESTATE TRANSFERS OR MORTGAGES.**
2. SUBJECT LANDS ARE ZONED AGRICULTURAL, ENVIRONMENTAL PROTECTION AND ENVIRONMENTAL PROTECTION OVERLAY.
3. SUBJECT LANDS HAVE AN OFFICIAL PLAN DESIGNATION OF PRIME AGRICULTURAL, GREENLANDS AND CORE GREENLANDS.
4. DISTANCES ON THIS PLAN ARE SHOWN IN METRES AND CAN BE CONVERTED TO FEET BY DIVIDING BY 0.3048.
5. DIMENSIONS ON THIS SKETCH ARE APPROXIMATE AND HAVE NOT BEEN VERIFIED BY SURVEY.
6. PROPERTY OWNERS: NANCY MARTIN & JOSEPH MARTIN.

THIS SKETCH WAS PREPARED ON  
 THE 31st DAY OF MARCH, 2022

*Jeffrey E. Buisman*  
 JEFFREY E. BUISMAN  
 ONTARIO LAND SURVEYOR



# Van Harten

**SURVEYING INC.**  
 LAND SURVEYORS and ENGINEERS

Kitchener/Waterloo Ph: 519-742-8371	Guelph Ph: 519-821-2763	Orangeville Ph: 519-940-4110
www.vanharten.com		info@vanharten.com
DRAWN BY: ARN	CHECKED BY: JEB	PROJECT No. 30641-21
Mar 31, 2022-2:53:48 PM		
G:\PILKINGTON\CON 5 EGR\ACAD\ZONE PLOT 12 13 (VALLEY SCHOOL) UTM.dwg		

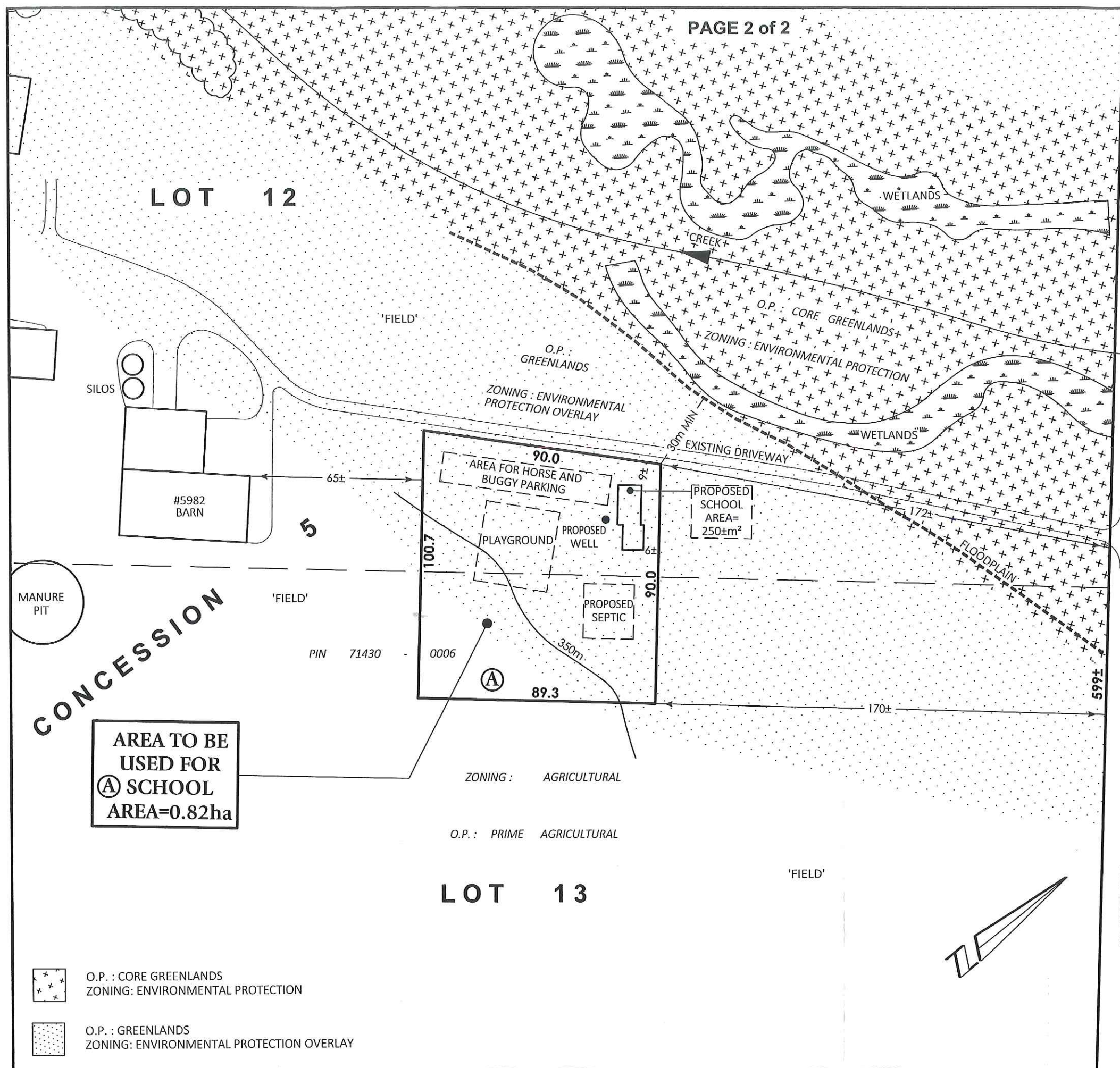

ROAD ALLOWANCE BETWEEN CONCESSIONS 4 AND 5

**EIGHTH LINE EAST**

20.12m WIDE

PIN 71430-0014

**AREA TO BE USED FOR**  
**(A) SCHOOL**  
**AREA=0.82ha**

-  O.P. : CORE GREENLANDS  
ZONING: ENVIRONMENTAL PROTECTION
-  O.P. : GREENLANDS  
ZONING: ENVIRONMENTAL PROTECTION OVERLAY

