



**GENERAL NOTES:**

- PROPOSED GRADING AND ELEVATIONS ARE SUBJECT TO CHANGE PENDING VERIFICATION OF STREET RECONSTRUCTION PLANS OF MOIR STREET (PLANS PREPARED BY OTHERS).
- OPSS AND OPSS STANDARD DRAWINGS CONSTITUTE PART OF THE SPECIFICATIONS STATED ON THIS DRAWING. ALL UNDERGROUND SERVICE MATERIALS AND INSTALLATIONS TO BE IN ACCORDANCE WITH THE LATEST APPLICABLE CODES AND STANDARDS.
- ALL DIMENSIONS AND LOCATIONS OF EXISTING SERVICES TO BE CONFIRMED BY THE CONTRACTOR PRIOR TO COMMENCING ANY CONSTRUCTION PROPOSED BY THIS DRAWING. ANY DISCREPANCIES ARE TO BE REPORTED TO THE PROJECT ENGINEER IMMEDIATELY.
- THE POSITION OF UNDERGROUND SERVICES AND CONDUITS ARE NOT NECESSARILY SHOWN ON THIS DRAWING, AND WHERE SHOWN, THE ACCURACY OF THE POSITION OF SUCH UTILITIES ARE NOT GUARANTEED. PRIOR TO COMMENCING ANY WORK, THE CONTRACTOR WILL INFORM HIMSELF OF THE EXACT LOCATION OF ALL SUCH UTILITIES AND ACCEPT ALL LIABILITY FOR ANY DAMAGE DONE TO THEM.
- THE OWNER IS RESPONSIBLE FOR THE COORDINATION OF ALL REQUIRED UTILITIES. THE OWNER SHALL BE RESPONSIBLE FOR ALL DITCHING, REGRADING AND RESTORATION WORK WITHIN THE TOWNSHIP'S ROAD ALLOWANCE AND TO THE CITY'S SATISFACTION, AS REQUIRED TO ACCOMMODATE THE PROPOSED DEVELOPMENT.
- THE OWNER IS RESPONSIBLE FOR SATISFYING HIMSELF THAT THERE IS ADEQUATE FIRE PROTECTION AVAILABLE FOR HIS PURPOSES.
- ALL ENTRANCE WORK TO MEET THE TOWNSHIP'S SATISFACTION.
- THE PAVEMENT STRUCTURE FOR THE PARKING AREAS SHALL COMPRISE 40mm HL3, 50mm HL8, 150mm GRANULAR 'A' AND 300mm GRANULAR 'B'.
- HEAVY DUTY ASPHALT WITHIN THE FIRE ROUTE SHALL COMPRISE AT MINIMUM 50mm HL3, 60mm HL8, 150mm GRANULAR 'A' AND 450mm GRANULAR 'B'.
- A GEOTECHNICAL CONSULTANT SHOULD BE RETAINED TO CARRY OUT NECESSARY INSPECTIONS AND TESTING DURING PARKING LOT CONSTRUCTION TO ENSURE PLACEMENT OF PROPER MATERIALS AND ADEQUATE COMPACTION.
- SEDIMENT AND EROSION CONTROLS TO BE PROVIDED DURING CONSTRUCTION.
- ENTRANCE PERMIT WILL BE REQUIRED PRIOR TO CONSTRUCTION OF PROPOSED SITE ENTRANCE.
- THE BOULEVARD AREA WITHIN THE ROAD ALLOWANCE THAT IS NOT COVERED WITH ASPHALT OR GRAVEL SHALL BE FINE GRADED AND COVERED WITH A MINIMUM OF 200mm OF TOPSOIL AND SEED.
- ALL PARKING GRANULAR MATERIAL SHALL BE COMPACTED TO 100% AND OTHER MISCELLANEOUS FILL MATERIAL BROUGHT TO THE SITE SHALL BE COMPACTED TO 95% PROCTOR (UNLESS OTHERWISE PRESCRIBED BY GEOTECHNICAL INVESTIGATION).
- FILL MATERIAL SHALL BE FREE OF DEBRIS INCLUDING LARGE ROCKS AND STONES. EXCESS DEBRIS AND MATERIAL SHALL BE REMOVED FROM THE SITE.
- ALL LANDSCAPED AREAS ON SITE SHALL BE PROVIDED WITH A MINIMUM OF 150mm OF TOPSOIL AND SEED OR SODDED.
- ANY AREAS NOT UNDER ACTIVE CONSTRUCTION SHALL BE STABILIZED WITH TOPSOIL AND SEED.
- PLAN IS BASED IN TOPOGRAPHIC SURVEY COMPLETED BY VAN HARTEN SURVEYING INC. DATED JANUARY 15, 2020.
- THIS IS NOT A PLAN OF SURVEY AND SHALL NOT BE USED FOR TRANSACTION OR MORTGAGE PURPOSES.

**SERVICING NOTES:**

- SERVICING DETAILS SHOWN ON THIS PLAN ARE PRELIMINARY PENDING VERIFICATION OF PROPOSED SERVICING DESIGN OF MOIR STREET (PREPARED BY OTHERS).
- ALL UTILITIES TO BE CONFIRMED BY THE OWNER PRIOR TO CONSTRUCTION.
- ALL SERVICES ARE TO BE INSTALLED TO APPROPRIATE OPSS AND TOWNSHIP OF CENTRE WELLINGTON STANDARDS.
- SANITARY SEWER PIPING TO BE 150mm Ø PVC DR 28.
- MANHOLE JOINTS ON ALL SANITARY SEWER CONNECTIONS TO BE WRAPPED TO PREVENT GROUNDWATER INFILTRATION WITH PETROLIUM TAPE.
- ALL STORM SEWERS TO BE PVC PIPE AND CONFORM TO OPSS 1820 AND ANY APPLICABLE CSA STANDARDS.
- ALL CATCHBASINS SHALL BE 600mm x 600mm PRECAST CONCRETE AS PER OPSS 705.010 - TYPE A.
- ALL MANHOLES AND CATCHBASIN MANHOLES SHOWN ON THIS DRAWING TO BE MINIMUM 1200mm Ø PRECAST CONCRETE AND CONFORM TO THE APPLICABLE OPSS.
- ALL WATERMANS SHALL BE CONSTRUCTED IN ACCORDANCE WITH OPSS 441.
- ALL MUNICIPAL OWNED WATER VALVES SHALL BE OPERATED BY THE TOWNSHIP, THE CONTRACTOR SHALL COORDINATE ALL NECESSARY VALVE OPERATIONS WITH THE TOWNSHIP PUBLIC WORKS DEPARTMENT.
- WHERE EXISTING WATERMANS ARE TAPPED, THE PIPE SURFACE AT THE LOCATION OF THE TAP SHALL BE CLEANED AND DISINFECTED USING A MINIMUM 1% SODIUM HYPOCHLORITE SOLUTION. WHERE APPLICABLE, THE DRILL/CUTTING/TAPPING BITS AND ALL SURFACES OF MAINSTOPS, SERVICE SADDLES, TAPPING SLEEVES AND VALVES WHICH WILL COME INTO CONTACT WITH DRINKING WATER SHALL LIKEWISE BE CLEANED AND DISINFECTED USING A MINIMUM 1% SODIUM HYPOCHLORITE SOLUTION IMMEDIATELY PRIOR TO INSTALLATION, IF ANY OF THE DISINFECTED SURFACES COME INTO CONTACT WITH THE SOIL AND/OR WATER IN THE EXCAVATION PRIOR TO USE, THE CLEANING AND DISINFECTION PROCEDURE SHALL BE REPEATED.
- THE CONTRACTOR SHALL PROVIDE AND MAINTAIN TEMPORARY WATER SUPPLY TO BUILDINGS AT ALL TIMES. THE CONTRACTOR WILL BE RESPONSIBLE FOR THE QUALITY TESTING OF THE TEMPORARY SUPPLY IN ACCORDANCE WITH TESTING PROCEDURES TO THE SATISFACTION OF THE CENTRE WELLINGTON ENVIRONMENTAL SERVICES DEPARTMENT.
- CONNECTION OF PROPOSED WATERMAIN TO MUNICIPAL WATERMAIN TO BE IN ACCORDANCE WITH TOWNSHIP OF CENTRE WELLINGTON STANDARDS.

**SEDIMENT AND EROSION CONTROL NOTES:**

- ALL SILT FENCING TO BE INSPECTED AND INSTALLED PRIOR TO THE COMMENCEMENT OF ANY GRADING OR EXCAVATING.
- EROSION PROTECTION TO BE PROVIDED AROUND ALL SWALES AND DITCHES.
- ALL PROPOSED AND EXISTING CATCHBASINS AND OTHER UTILITY STRUCTURES TO BE PROVIDED WITH SILT SACS DURING CONSTRUCTION.
- ADDITIONAL EROSION CONTROL MEASURES MAY BE REQUIRED AS SITE DEVELOPMENT PROGRESSES. THE CONTRACTOR IS RESPONSIBLE TO PROVIDE ANY ADDITIONAL EROSION CONTROL STRUCTURES.
- EROSION CONTROL STRUCTURES ARE TO BE MONITORED ON A WEEKLY BASIS, BEFORE AND AFTER SIGNIFICANT RAINFALL EVENTS. ANY DAMAGE TO STRUCTURES REPAIRED IMMEDIATELY. SEDIMENTS ARE TO BE REMOVED WHEN THE HEIGHT OF ACCUMULATION REACHES A MAXIMUM FOR THE FENCE AND THE CLOGGED FILTER MATERIALS MUST BE REPLACED AS NEEDED OR AS REQUESTED BY THE TOWN.
- ALL EROSION CONTROL STRUCTURES ARE TO REMAIN IN PLACE UNTIL ALL DISTURBED GROUND SURFACES HAVE BEEN STABILIZED EITHER BY PAVING OR RESTORATION OF VEGETATIVE GROUND COVER.
- DE-WATERING WILL NOT BE PERMITTED DURING CONSTRUCTION. SHOULD DE-WATERING BE REQUIRED, A SEPARATE PLAN AND APPROVAL FROM THE GRCA SHALL BE OBTAINED.
- NO ALTERNATIVE METHODS OF EROSION PROTECTION SHALL BE PERMITTED UNLESS APPROVED BY THE DESIGN CONSULTANT AND THE CITY OF GUELPH.
- THE CONTRACTOR IS TO ENSURE THE SILT FENCING IS FUNCTIONING AS INTENDED.
- ANY DAMAGED ESC MEASURES ARE TO BE REPLACED IMMEDIATELY WITHIN 48 HOURS OF INSPECTION.
- SEDIMENT TO BE REMOVED FROM THE SEDIMENT BARRIER ONCE IT HAS REACHED A DEPTH OF 300 mm. ALL ACCUMULATED SEDIMENT SHALL BE REMOVED PRIOR TO REMOVING THE SILT FENCING.
- THE CONTRACTOR IS RESPONSIBLE FOR ENSURING MUNICIPAL ROADWAYS AND SIDEWALKS ARE CLEANED OF ALL SEDIMENTS FROM VEHICULAR TRACKING ETC. TO AND FROM THE SITE AT THE END OF EACH WORKING DAY.
- EROSION AND SEDIMENT CONTROL (ESC) PLAN IS A DYNAMIC DOCUMENT, WHICH MAY BE SUBJECT TO CHANGE OR MODIFICATIONS AS A RESULT OF SITE DEVELOPMENTS OR CHANGES ON SITE. ANY DEVIATION FROM APPROVED PLANS MUST BE DESIGNED BY A QUALIFIED PROFESSIONAL.
- IT IS EVERYONE'S RESPONSIBILITY TO PREVENT CONSTRUCTION RELATED SEDIMENT FROM IMPACTING AQUATIC RESOURCES AND OTHER NATURAL FEATURES.
- NO PUMPING OF SEDIMENT LADEN RUNOFF FROM ONSITE TO THE WETLAND IS ALLOWED AT ANY TIME.
- ALL ACTIVITIES, INCLUDING MAINTENANCE PROCEDURES, WILL BE CONTROLLED TO PREVENT THE ENTRY OF PETROLEUM PRODUCTS, DEBRIS, RUBBLE, CONCRETE, OR OTHER DELETERIOUS SUBSTANCES IN THE WATER. VEHICULAR RE-FUELLING AND MAINTENANCE WILL BE CONDUCTED A MINIMUM OF 30 m FROM THE WATER.
- AN AFTER-HOURS CONTACT NUMBER IS TO BE VISIBLY POSTED ON-SITE FOR EMERGENCIES. ALL THE PLANS SHOULD HAVE NAME AND CONTACT INFO OF THE PERSON RESPONSIBLE FOR ESC MEASURES.
- ANY SEDIMENT SPILL FROM THE SITE SHOULD BE REPORTED TO MINISTRY OF ENVIRONMENT (SPILL ACTION CENTRE) AT 1-800-268-0060.
- ADDITIONAL EROSION AND SEDIMENT CONTROL MATERIALS (IE SILT FENCE, STRAW BALES, CLEAR STONES ... ETC.) ARE TO BE KEPT ON SITE FOR EMERGENCIES AND REPAIRS.

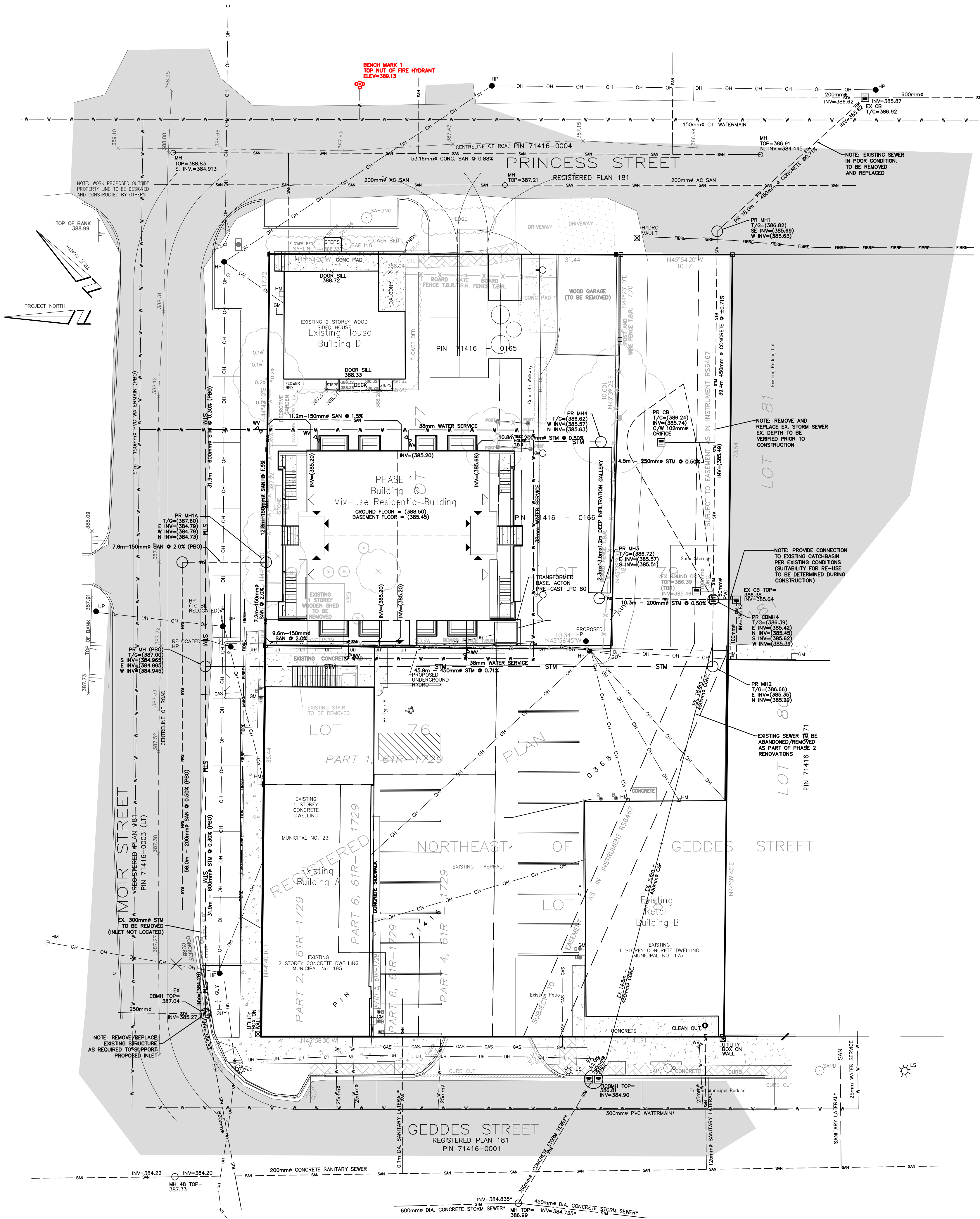

**LEGEND**

	LIGHT STANDARD
	UNDERGROUND FIBRE
	OVERHEAD HYDRO
	UNDERGROUND HYDRO
	GAS LINE
	STORM SEWER
	SANITARY SEWER
	WATERMAIN
	FENCE
	VHS PROPOSED GRADE
	TRITON PROPOSED GRADE
	SLOPE
	DIRECTION OF FLOW
	CENTRELINE OF ROAD
	EXISTING ELEVATION
	GUY WIRE
	HYDRO POLE
	GAS METER
	HYDRO METER
	BELL PEDESTAL
	DECIDUOUS TREE
	DECIDUOUS TREE TO BE REMOVED
	HYDRO POLE CATCH BASIN
	MANHOLE
	WATER VALVE
	BOLLARD
	BENCH MARK
	SAPLING
	SIGN
	DENOTES TO BE REMOVED
	DENOTES PROPOSED BY OTHERS
	DENOTES PROPOSED LANDSCAPE AREA BY OTHERS
	EXISTING PAVESTONE
	EXISTING ASPHALT
	EXISTING GRAVEL
	EXISTING CONCRETE
	PHASE 1
	EXISTING CURB CUT
	PHASE 2

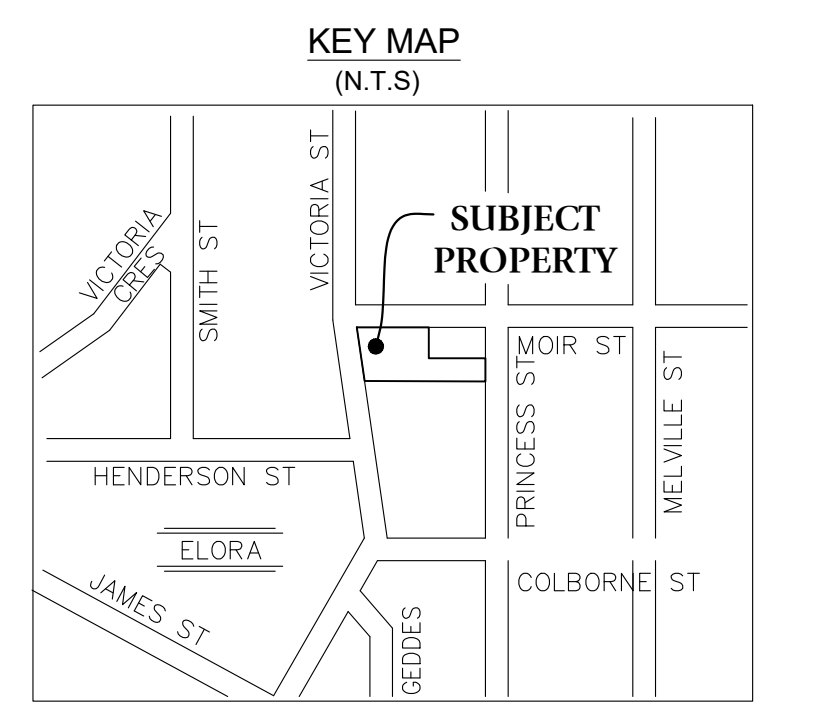

**CAUTION:**  
 - THIS IS NOT A PLAN OF SURVEY AND SHALL NOT BE USED FOR TRANSACTION OR MORTGAGE PURPOSES.  
 - THIS SKETCH IS PROTECTED BY COPYRIGHT.

**BENCHMARK:**  
 ELEVATIONS ARE BASED ON GPS OBSERVATIONS TO PERMANENT REFERENCE STATIONS IN THE NAD83 (CSRS-2010) COORDINATE SYSTEM AND HAVE BEEN CORRECTED TO ORTHOMETRIC ELEVATIONS ON THE CGVD28 DATUM (1978 ADJUSTMENT) WITH GEOID MODEL HTV2.0, AS SUPPLIED BY NATURAL RESOURCES CANADA.  
 SITE BENCH MARK 1: TOP NUT OF FIRE HYDRANT, ELEV=389.13m.  
 SITE BENCH MARK 2: TOP OF 0.7x0.7 CATCH BASIN, ELEV=386.52m.

**PROPERTY DESCRIPTION:**  
 • PIN 71416-0168, PIN 71416-0169, & PIN 71416-0170  
 • REGISTERED PLAN 181  
 • (GEOGRAPHIC VILLAGE OF ELORA)  
 • TOWNSHIP OF CENTRE WELLINGTON  
 • COUNTY OF WELLINGTON

**BOUNDARY NOTE:**  
 BOUNDARY BEARINGS AND DISTANCES AS PER SURVEYOR'S REAL PROPERTY REPORT BY VAN HARTEN SURVEYING INC., PROJECT 26629-18.

NO.	REVISION	BY	DATE
2	INITIAL SUBMISSION	MAMV	DEC 8-21
1	FOR COORDINATION	MAMV	SEP 21-21

**DRAWING REVISION SCHEDULE**

**LOT DEVELOPMENT PLAN FOR:**  
**23, 175, & 195 GEDDES STREET**  
**ALL OF LOTS 76, & 78**  
**PART OF LOT 79**  
**REGISTERED PLAN 181**  
**TOWNSHIP OF CENTRE WELLINGTON**  
**COUNTY OF WELLINGTON**

PROJECT No. 26629-18  
 DRAWING SCALE 1 : 200

**METRIC:**  
 DISTANCES SHOWN ON THIS PLAN ARE IN METRES AND CAN BE CONVERTED TO FEET BY DIVIDING BY 0.3048.

**SERVICING: PHASE 1**

SHEET  
**2**  
 OF  
**5**

PREPARED FOR:  
**DAVE GILLIS**

**Van Harten SURVEYING INC.**  
 LAND SURVEYORS AND ENGINEERS

Kitchener/Waterloo Ph: 519-742-8371 Guelph Ph: 519-821-2763 Orangeville Ph: 519-940-4110

www.vanharten.com info@vanharten.com

DRAWN BY: RKH DESIGN BY: MAMV CHECKED BY: MAMV

**CALL BEFORE YOU DIG**  
 THE LOCATION OF SERVICES ON THIS DRAWING ARE ONLY APPROXIMATE AND BASED ON SURFACE FEATURES LOCATED AT THE TIME OF THE TOPOGRAPHIC SURVEY. PRIOR TO ANY CONSTRUCTION IT IS THE RESPONSIBILITY OF THE CONTRACTOR/BUILDER TO ENSURE THE EXACT LOCATION OF ALL UTILITIES.

**GENERAL NOTES:**

- PROPOSED GRADING AND ELEVATIONS ARE SUBJECT TO CHANGE PENDING VERIFICATION OF STREET RECONSTRUCTION PLANS OF MOIR STREET (PLANS PREPARED BY OTHERS).
- OPSS AND OPSD STANDARD DRAWINGS CONSTITUTE PART OF THE SPECIFICATIONS STATED ON THIS DRAWING. ALL UNDERGROUND SERVICE MATERIALS AND INSTALLATIONS TO BE IN ACCORDANCE WITH THE LATEST APPLICABLE CODES AND STANDARDS.
- ALL DIMENSIONS AND LOCATIONS OF EXISTING SERVICES TO BE CONFIRMED BY THE CONTRACTOR PRIOR TO COMMENCING ANY CONSTRUCTION PROPOSED BY THIS DRAWING. ANY DISCREPANCIES ARE TO BE REPORTED TO THE PROJECT ENGINEER IMMEDIATELY.
- THE POSITION OF UNDERGROUND SERVICES AND CONDUITS ARE NOT NECESSARILY SHOWN ON THIS DRAWING, AND WHERE SHOWN, THE ACCURACY OF THE POSITION OF SUCH UTILITIES ARE NOT GUARANTEED. PRIOR TO COMMENCING ANY WORK, THE CONTRACTOR WILL INFORM HIMSELF OF THE EXACT LOCATION OF ALL SUCH UTILITIES AND ACCEPT ALL LIABILITY FOR ANY DAMAGE DONE TO THEM.
- THE OWNER IS RESPONSIBLE FOR THE COORDINATION OF ALL REQUIRED UTILITIES. THE OWNER SHALL BE RESPONSIBLE FOR ALL DITCHING, REGRADING AND RESTORATION WORK WITHIN THE TOWNSHIP'S ROAD ALLOWANCE AND TO THE CITY'S SATISFACTION, AS REQUIRED TO ACCOMMODATE THE PROPOSED DEVELOPMENT.
- THE OWNER IS RESPONSIBLE FOR SATISFYING HIMSELF THAT THERE IS ADEQUATE FIRE PROTECTION AVAILABLE FOR HIS PURPOSES.
- ALL ENTRANCES TO MEET THE TOWNSHIP'S SATISFACTION.
- THE PAVEMENT STRUCTURE FOR THE PARKING AREAS SHALL COMPRISE 40mm HL3, 50mm HL8, 150mm GRANULAR 'A' AND 300mm GRANULAR 'B'.
- HEAVY DUTY ASPHALT WITHIN THE FIRE ROUTE SHALL COMPRISE AT MINIMUM 50mm HL3, 60mm HL8, 150mm GRANULAR 'A' AND 450mm GRANULAR 'B'.
- A GEOTECHNICAL CONSULTANT SHOULD BE RETAINED TO CARRY OUT NECESSARY INSPECTIONS AND TESTING DURING PARKING LOT CONSTRUCTION TO ENSURE PLACEMENT OF PROPER MATERIALS AND ADEQUATE COMPACTION.
- SEDIMENT AND EROSION CONTROLS TO BE PROVIDED DURING CONSTRUCTION.
- ENTRANCE PERMIT WILL BE REQUIRED PRIOR TO CONSTRUCTION OF PROPOSED SITE ENTRANCE.
- THE BOULEVARD AREA WITHIN THE ROAD ALLOWANCE THAT IS NOT COVERED WITH ASPHALT OR GRAVEL SHALL BE FINE GRADED AND COVERED WITH A MINIMUM OF 200mm OF TOPSOIL AND SEEDED.
- ALL PARKING GRANULAR MATERIAL SHALL BE COMPACTED TO 100% AND OTHER MISCELLANEOUS FILL MATERIAL BROUGHT TO THE SITE SHALL BE COMPACTED TO 95% PROCTOR (UNLESS OTHERWISE PRESCRIBED BY GEOTECHNICAL INVESTIGATION).
- FILL MATERIAL SHALL BE FREE OF DEBRIS INCLUDING LARGE ROCKS AND STONES. EXCESS DEBRIS AND MATERIAL SHALL BE REMOVED FROM THE SITE.
- ALL LANDSCAPED AREAS ON SITE SHALL BE PROVIDED WITH A MINIMUM OF 150mm OF TOPSOIL AND SEEDED OR SODDED.
- ANY AREAS NOT UNDER ACTIVE CONSTRUCTION SHALL BE STABILIZED WITH TOPSOIL AND SEED.
- PLAN IS BASED IN TOPOGRAPHIC SURVEY COMPLETED BY VAN HARTEN SURVEYING INC. DATED JANUARY 15, 2020.
- THIS IS NOT A PLAN OF SURVEY AND SHALL NOT BE USED FOR TRANSACTION OR MORTGAGE PURPOSES.

**SERVICING NOTES:**

- SERVICING DETAILS SHOWN ON THIS PLAN ARE PRELIMINARY PENDING VERIFICATION OF PROPOSED SERVICING DESIGN OF MOIR STREET (PREPARED BY OTHERS).
- ALL UTILITIES TO BE CONFIRMED BY THE OWNER PRIOR TO CONSTRUCTION.
- ALL SERVICES ARE TO BE INSTALLED TO APPROPRIATE OPSS AND TOWNSHIP OF CENTRE WELLINGTON STANDARDS.
- SANITARY SEWER PIPING TO BE 150mmØ PVC DN 28.
- MANHOLE JOINTS ON ALL SANITARY SEWER CONNECTIONS TO BE WRAPPED TO PREVENT GROUNDWATER INFILTRATION WITH PETROLATUM TAPE.
- ALL STORM SEWERS TO BE PVC PIPE AND CONFORM TO OPSS 1820 AND ANY APPLICABLE CSA STANDARDS.
- ALL CATCHBASINS SHALL BE 600mm x 600mm PRECAST CONCRETE AS PER OPSD 705.010 - TYPE A.
- ALL MANHOLES AND CATCHBASIN MANHOLES SHOWN ON THIS DRAWING TO BE MINIMUM 1200mmØ PRECAST CONCRETE AND CONFORM TO THE APPLICABLE OPSD.
- ALL WATERMANS SHALL BE CONSTRUCTED IN ACCORDANCE WITH OPSS 441.
- ALL MUNICIPAL OWNED WATER VALVES SHALL BE OPERATED BY THE TOWNSHIP. THE CONTRACTOR SHALL COORDINATE ALL NECESSARY VALVE OPERATIONS WITH THE TOWNSHIP PUBLIC WORKS DEPARTMENT.
- WHERE EXISTING WATERMANS ARE TAPPED, THE PIPE SURFACE AT THE LOCATION OF THE TAP SHALL BE CLEANED AND DISINFECTED USING A MINIMUM 1% SODIUM HYPOCHLORITE SOLUTION, WHERE APPLICABLE. THE DRILL/CUTTING/TAPPING BITS AND ALL SURFACES OF MANHOLES, SERVICE SADES, TAPPING SLEEVES AND VALVES WHICH WILL COME INTO CONTACT WITH DRINKING WATER SHALL LIKEWISE BE CLEANED AND DISINFECTED USING A MINIMUM 1% SODIUM HYPOCHLORITE SOLUTION IMMEDIATELY PRIOR TO INSTALLATION. IF ANY OF THE DISINFECTED SURFACES COME INTO CONTACT WITH THE SOIL AND/OR WATER IN THE EXCAVATION PRIOR TO USE, THE CLEANING AND DISINFECTION PROCEDURE SHALL BE REPEATED.
- THE CONTRACTOR SHALL PROVIDE AND MAINTAIN TEMPORARY WATER SUPPLY TO BUILDINGS AT ALL TIMES. THE CONTRACTOR WILL BE RESPONSIBLE FOR THE QUALITY TESTING OF THE TEMPORARY SUPPLY IN ACCORDANCE WITH TESTING PROCEDURES TO THE SATISFACTION OF THE CENTRE WELLINGTON ENVIRONMENTAL SERVICES DEPARTMENT.
- CONNECTION OF PROPOSED WATERMAIN TO MUNICIPAL WATERMAIN TO BE IN ACCORDANCE WITH TOWNSHIP OF CENTRE WELLINGTON STANDARDS.

**SEDIMENT AND EROSION CONTROL NOTES:**

- ALL SILT FENCING TO BE INSPECTED AND INSTALLED PRIOR TO THE COMMENCEMENT OF ANY GRADING OR EXCAVATING.
- EROSION PROTECTION TO BE PROVIDED AROUND ALL SWALES AND DITCHES.
- ALL PROPOSED AND EXISTING CATCHBASINS AND OTHER UTILITY STRUCTURES TO BE PROVIDED WITH SILT SACS DURING CONSTRUCTION.
- ADDITIONAL EROSION CONTROL MEASURES MAY BE REQUIRED AS SITE DEVELOPMENT PROGRESSES. THE CONTRACTOR IS RESPONSIBLE TO PROVIDE ANY ADDITIONAL EROSION CONTROL STRUCTURES.
- EROSION CONTROL STRUCTURES ARE TO BE MONITORED ON A WEEKLY BASIS, BEFORE AND AFTER SIGNIFICANT RAINFALL EVENTS. ANY DAMAGE TO STRUCTURES REPAIRED IMMEDIATELY. SEDIMENTS ARE TO BE REMOVED WHEN THE HEIGHT OF ACCUMULATION REACHES A MAXIMUM FOR THE FENCE AND THE CLOGGED FILTER MATERIALS MUST BE REPLACED AS NEEDED OR AS REQUESTED BY THE TOWN.
- ALL EROSION CONTROL STRUCTURES ARE TO REMAIN IN PLACE UNTIL ALL DISTURBED GROUND SURFACES HAVE BEEN STABILIZED EITHER BY PAVING OR RESTORATION OF VEGETATIVE GROUND COVER.
- DE-WATERING WILL NOT BE PERMITTED DURING CONSTRUCTION. SHOULD DE-WATERING BE REQUIRED, A SEPARATE PLAN AND APPROVAL FROM THE GRCA SHALL BE OBTAINED.
- NO ALTERNATIVE METHODS OF EROSION PROTECTION SHALL BE PERMITTED UNLESS APPROVED BY THE DESIGN CONSULTANT AND THE CITY OF GUELPH.
- THE CONTRACTOR IS TO ENSURE THE SILT FENCING IS FUNCTIONING AS INTENDED.
- ANY DAMAGED ESC MEASURES ARE TO BE REPLACED IMMEDIATELY WITHIN 48 HOURS OF INSPECTION.
- SEDIMENT TO BE REMOVED FROM THE SEDIMENT BARRIER ONCE IT HAS REACHED A DEPTH OF 300 mm. ALL ACCUMULATED SEDIMENT SHALL BE REMOVED PRIOR TO REMOVING THE SILT FENCING.
- THE CONTRACTOR IS RESPONSIBLE FOR ENSURING MUNICIPAL ROADWAYS AND SIDEWALKS ARE CLEANED OF ALL SEDIMENTS FROM VEHICULAR TRACKING ETC. TO AND FROM THE SITE AT THE END OF EACH WORKING DAY.
- EROSION AND SEDIMENT CONTROL (ESC) PLAN IS A DYNAMIC DOCUMENT, WHICH MAY BE SUBJECT TO CHANGE OR MODIFICATIONS AS A RESULT OF SITE DEVELOPMENTS OR CHANGES ON SITE. ANY DEVIATION FROM APPROVED PLANS MUST BE DESIGNED BY A QUALIFIED PROFESSIONAL.
- IT IS EVERYONE'S RESPONSIBILITY TO PREVENT CONSTRUCTION RELATED SEDIMENT FROM IMPACTING AQUATIC RESOURCES AND OTHER NATURAL FEATURES.
- NO PUMPING OF SEDIMENT LADEN RUNOFF FROM ONSITE TO THE WETLAND IS ALLOWED AT ANY TIME.
- ALL ACTIVITIES, INCLUDING MAINTENANCE PROCEDURES, WILL BE CONTROLLED TO PREVENT THE ENTRY OF PETROLEUM PRODUCTS, DEBRIS, RUBBLE, CONCRETE, OR OTHER DELETERIOUS SUBSTANCES IN THE WATER. VEHICULAR RE-FUELLING AND MAINTENANCE WILL BE CONDUCTED AT A MINIMUM OF 30 m FROM THE WATER.
- AN AFTER-HOURS CONTACT NUMBER IS TO BE VISIBLY POSTED ON-SITE FOR EMERGENCIES. ALL THE PLANS SHOULD HAVE NAME AND CONTACT INFO OF THE PERSON RESPONSIBLE FOR ESC MEASURES.
- ANY SEDIMENT SPILL FROM THE SITE SHOULD BE REPORTED TO MINISTRY OF ENVIRONMENT (SPILL ACTION CENTRE) AT 1-800-268-6060.
- ADDITIONAL EROSION AND SEDIMENT CONTROL MATERIALS (IE SILT FENCE, STRAW BALES, CLEAR STONES ... ETC.) ARE TO BE KEPT ON SITE FOR EMERGENCIES AND REPAIRS.



**LEGEND**

- FIBRE - FIBRE
- OH - OH
- UH - UH
- GAS - GAS
- STM - STM
- SAW - SAW
- W - W

+ (325.09)  
 + (325.09)

x 206.55  
 GUY  
 HP  
 GM  
 HM  
 BELL  
 DECIDUOUS TREE  
 DECIDUOUS TREE TO BE REMOVED  
 HP  
 MH  
 WV  
 B  
 B  
 T.B.R.  
 P.B.O.  
 L.A.

EXISTING PAVESTONE  
 EXISTING GRAVEL  
 PHASE 1  
 PHASE 2  
 EXISTING ASPHALT  
 EXISTING CONCRETE  
 EXISTING CURB CUT

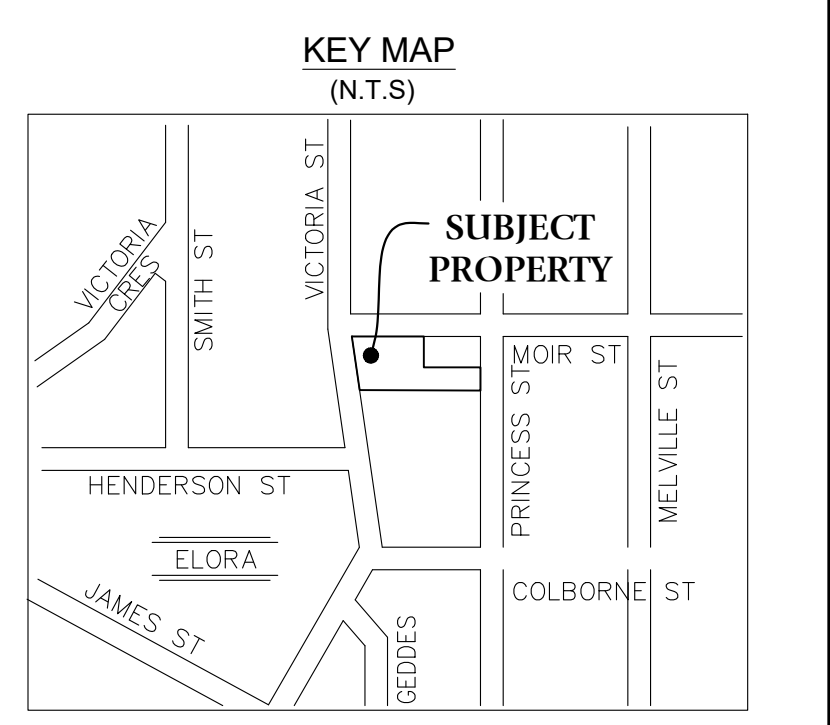

**CAUTION:**

- THIS IS NOT A PLAN OF SURVEY AND SHALL NOT BE USED FOR TRANSACTION OR MORTGAGE PURPOSES.

- THIS SKETCH IS PROTECTED BY COPYRIGHT. ©

**BENCHMARK:**

ELEVATIONS ARE BASED ON GPS OBSERVATIONS TO PERMANENT REFERENCE STATIONS IN THE NAD83 (CSRS-2010) COORDINATE SYSTEM AND HAVE BEEN CORRECTED TO ORTHOMETRIC ELEVATIONS ON THE CGVD28 DATUM [1978 ADJUSTMENT] WITH GEOID MODEL HTV2.0, AS SUPPLIED BY NATURAL RESOURCES CANADA.

SITE BENCH MARK 1: TOP NUT OF FIRE HYDRANT, ELEV=389.13m.

SITE BENCH MARK 2: TOP OF 0.7X0.7 CATCH BASIN, ELEV=386.52m.

**PROPERTY DESCRIPTION:**

- PIN 71416-0168, PIN 71416-0169, & PIN 71416-0170
- 23, 175, & 195 GEDDES STREET
- REGISTERED PLAN 181
- (GEOGRAPHIC VILLAGE OF ELORA)
- TOWNSHIP OF CENTRE WELLINGTON
- COUNTY OF WELLINGTON

**BOUNDARY NOTE:**

BOUNDARY BEARINGS AND DISTANCES AS PER SURVEYOR'S REAL PROPERTY REPORT BY VAN HARTEN SURVEYING INC., PROJECT 26629-18.

NO.	REVISION	BY	DATE
2	INITIAL SUBMISSION	MAMV	DEC 8-21
1	FOR COORDINATION	MAMV	SEP 21-21

**DRAWING REVISION SCHEDULE**

**LOT DEVELOPMENT PLAN FOR:**

**23, 175, & 195 GEDDES STREET**

**ALL OF LOTS 76, & 78**

**PART OF LOT 79**

**REGISTERED PLAN 181**

**TOWNSHIP OF CENTRE WELLINGTON**

**COUNTY OF WELLINGTON**

PROJECT No. 26629-18

DRAWING SCALE 1 : 200

**METRIC:**

DISTANCES SHOWN ON THIS PLAN ARE IN METRES AND CAN BE CONVERTED TO FEET BY DIVIDING BY 0.3048.

**GRADING: PHASE 2**

SHEET 3 OF 5

PREPARED FOR:

**DAVE GILLIS**

**Van Harten SURVEYING INC.**

LAND SURVEYORS and ENGINEERS

Kitchener/Waterloo Ph: 519-742-8371 Guelph Ph: 519-821-2763 Orangeville Ph: 519-940-4110

www.vanharten.com info@vanharten.com

DRAWN BY: RKH DESIGN BY: MAMV CHECKED BY: MAMV

Dec 08, 2021 12:20pm  
 C:\Users\MIKE-1\VAU\AppData\Local\Temp\AcPublish\_44616\SP.LOTS 76,78,79.GLLS (2)

**CALL BEFORE YOU DIG**

THE LOCATION OF SERVICES ON THIS DRAWING ARE ONLY APPROXIMATE AND BASED ON SURFACE FEATURES LOCATED AT THE TIME OF THE TOPOGRAPHIC SURVEY. PRIOR TO ANY CONSTRUCTION IT IS THE RESPONSIBILITY OF THE CONTRACTOR/BUILDER TO ENSURE THE EXACT LOCATION OF ALL UTILITIES.

**GENERAL NOTES:**

- PROPOSED GRADING AND ELEVATIONS ARE SUBJECT TO CHANGE PENDING VERIFICATION OF STREET RECONSTRUCTION PLANS OF MOIR STREET (PLANS PREPARED BY OTHERS).
- OPSS AND OPSS STANDARD DRAWINGS CONSTITUTE PART OF THE SPECIFICATIONS STATED ON THIS DRAWING. ALL UNDERGROUND SERVICE MATERIALS AND INSTALLATIONS TO BE IN ACCORDANCE WITH THE LATEST APPLICABLE CODES AND STANDARDS.
- ALL DIMENSIONS AND LOCATIONS OF EXISTING SERVICES TO BE CONFIRMED BY THE CONTRACTOR PRIOR TO COMMENCING ANY CONSTRUCTION PROPOSED BY THIS DRAWING. ANY DISCREPANCIES ARE TO BE REPORTED TO THE PROJECT ENGINEER IMMEDIATELY.
- THE POSITION OF UNDERGROUND SERVICES AND CONDUITS ARE NOT NECESSARILY SHOWN ON THIS DRAWING, AND WHERE SHOWN, THE ACCURACY OF THE POSITION OF SUCH UTILITIES ARE NOT GUARANTEED. PRIOR TO COMMENCING ANY WORK, THE CONTRACTOR WILL INFORM HIMSELF OF THE EXACT LOCATION OF ALL SUCH UTILITIES AND ACCEPT ALL LIABILITY FOR ANY DAMAGE DONE TO THEM.
- THE OWNER IS RESPONSIBLE FOR THE COORDINATION OF ALL REQUIRED UTILITIES. THE OWNER SHALL BE RESPONSIBLE FOR ALL DITCHING, REGRADING AND RESTORATION WORK WITHIN THE TOWNSHIP'S ROAD ALLOWANCE AND TO THE CITY'S SATISFACTION, AS REQUIRED TO ACCOMMODATE THE PROPOSED DEVELOPMENT.
- THE OWNER IS RESPONSIBLE FOR SATISFYING HIMSELF THAT THERE IS ADEQUATE FIRE PROTECTION AVAILABLE FOR HIS PURPOSES.
- ALL ENTRANCE WORK TO MEET THE TOWNSHIP'S SATISFACTION.
- THE PAVEMENT STRUCTURE FOR THE PARKING AREAS SHALL COMPRISE 40mm HL3, 50mm HL8, 150mm GRANULAR 'A' AND 300mm GRANULAR 'B'.
- HEAVY DUTY ASPHALT WITHIN THE FIRE ROUTE SHALL COMPRISE AT MINIMUM 50mm HL3, 60mm HL8, 150mm GRANULAR 'A' AND 450mm GRANULAR 'B'.
- A GEOTECHNICAL CONSULTANT SHOULD BE RETAINED TO CARRY OUT NECESSARY INSPECTIONS AND TESTING DURING PARKING LOT CONSTRUCTION TO ENSURE PLACEMENT OF PROPER MATERIALS AND ADEQUATE COMPACTION.
- SEDIMENT AND EROSION CONTROLS TO BE PROVIDED DURING CONSTRUCTION.
- ENTRANCE PERMIT WILL BE REQUIRED PRIOR TO CONSTRUCTION OF PROPOSED SITE ENTRANCE.
- THE BOULEVARD AREA WITHIN THE ROAD ALLOWANCE THAT IS NOT COVERED WITH ASPHALT OR GRAVEL SHALL BE FIRE GRADED AND COVERED WITH A MINIMUM OF 200mm OF TOPSOIL AND SEED.
- ALL PARKING GRANULAR MATERIAL SHALL BE COMPACTED TO 100% AND OTHER MISCELLANEOUS FILL MATERIAL BROUGHT TO THE SITE SHALL BE COMPACTED TO 95% PROCTOR (UNLESS OTHERWISE PRESCRIBED BY GEOTECHNICAL INVESTIGATION).
- FILL MATERIAL SHALL BE FREE OF DEBRIS INCLUDING LARGE ROCKS AND STONES. EXCESS DEBRIS AND MATERIAL SHALL BE REMOVED FROM THE SITE.
- ALL LANDSCAPED AREAS ON SITE SHALL BE PROVIDED WITH A MINIMUM OF 150mm OF TOPSOIL AND SEED OR SODDED.
- ANY AREAS NOT UNDER ACTIVE CONSTRUCTION SHALL BE STABILIZED WITH TOPSOIL AND SEED.
- PLAN IS BASED IN TOPOGRAPHIC SURVEY COMPLETED BY VAN HARTEN SURVEYING INC. DATED JANUARY 15, 2020.
- THIS IS NOT A PLAN OF SURVEY AND SHALL NOT BE USED FOR TRANSACTION OR MORTGAGE PURPOSES.

**SERVICING NOTES:**

- SERVICING DETAILS SHOWN ON THIS PLAN ARE PRELIMINARY PENDING VERIFICATION OF PROPOSED SERVICING DESIGN OF MOIR STREET (PREPARED BY OTHERS).
- ALL UTILITIES TO BE CONFIRMED BY THE OWNER PRIOR TO CONSTRUCTION.
- ALL SERVICES ARE TO BE INSTALLED TO APPROPRIATE OPSS AND TOWNSHIP OF CENTRE WELLINGTON STANDARDS.
- SANITARY SEWER PIPING TO BE 150mm Ø PVC DR 28.
- MANHOLE JOINTS ON ALL SANITARY SEWER CONNECTIONS TO BE WRAPPED TO PREVENT GROUNDWATER INFILTRATION WITH PETROLIUM TAPE.
- ALL STORM SEWERS TO BE PVC PIPE AND CONFORM TO OPSS 1820 AND ANY APPLICABLE CSA STANDARDS.
- ALL CATCHBASINS SHALL BE 600mm x 600mm PRECAST CONCRETE AS PER OPSS 705.010 - TYPE A.
- ALL MANHOLES AND CATCHBASIN MANHOLES SHOWN ON THIS DRAWING TO BE MINIMUM 1200mm Ø PRECAST CONCRETE AND CONFORM TO THE APPLICABLE OPSS.
- ALL WATERMANS SHALL BE CONSTRUCTED IN ACCORDANCE WITH OPSS 441.
- ALL MUNICIPAL OWNED WATER VALVES SHALL BE OPERATED BY THE TOWNSHIP, THE CONTRACTOR SHALL COORDINATE ALL NECESSARY VALVE OPERATIONS WITH THE TOWNSHIP PUBLIC WORKS DEPARTMENT.
- WHERE EXISTING WATERMANS ARE TAPPED, THE PIPE SURFACE AT THE LOCATION OF THE TAP SHALL BE CLEANED AND DISINFECTED USING A MINIMUM 1% SODIUM HYPOCHLORITE SOLUTION, WHERE APPLICABLE. THE DRILL/CUTTING/TAPPING BITS AND ALL SURFACES OF MAINSTOPS, SERVICE SADDLES, TAPPING SLEEVES AND VALVES WHICH WILL COME INTO CONTACT WITH DRINKING WATER SHALL LIKEWISE BE CLEANED AND DISINFECTED USING A MINIMUM 1% SODIUM HYPOCHLORITE SOLUTION IMMEDIATELY PRIOR TO INSTALLATION, IF ANY OF THE DISINFECTED SURFACES COME INTO CONTACT WITH THE SOIL AND/OR WATER IN THE EXCAVATION PRIOR TO USE, THE CLEANING AND DISINFECTING PROCEDURE SHALL BE REPEATED.
- THE CONTRACTOR SHALL PROVIDE AND MAINTAIN TEMPORARY WATER SUPPLY TO BUILDINGS AT ALL TIMES. THE CONTRACTOR WILL BE RESPONSIBLE FOR THE QUALITY TESTING OF THE TEMPORARY SUPPLY IN ACCORDANCE WITH TESTING PROCEDURES TO THE SATISFACTION OF THE CENTRE WELLINGTON ENVIRONMENTAL SERVICES DEPARTMENT.
- CONNECTION OF PROPOSED WATERMAIN TO MUNICIPAL WATERMAIN TO BE IN ACCORDANCE WITH TOWNSHIP OF CENTRE WELLINGTON STANDARDS.

**SEDIMENT AND EROSION CONTROL NOTES:**

- ALL SILT FENCING TO BE INSPECTED AND INSTALLED PRIOR TO THE COMMENCEMENT OF ANY GRADING OR EXCAVATING.
- EROSION PROTECTION TO BE PROVIDED AROUND ALL SWALES AND DITCHES.
- ALL PROPOSED AND EXISTING CATCHBASINS AND OTHER UTILITY STRUCTURES TO BE PROVIDED WITH SILT SACS DURING CONSTRUCTION.
- ADDITIONAL EROSION CONTROL MEASURES MAY BE REQUIRED AS SITE DEVELOPMENT PROGRESSES. THE CONTRACTOR IS RESPONSIBLE TO PROVIDE ANY ADDITIONAL EROSION CONTROL STRUCTURES.
- EROSION CONTROL STRUCTURES ARE TO BE MONITORED ON A WEEKLY BASIS, BEFORE AND AFTER SIGNIFICANT RAINFALL EVENTS. ANY DAMAGE TO STRUCTURES REPAIRED IMMEDIATELY. SEDIMENTS ARE TO BE REMOVED WHEN THE HEIGHT OF ACCUMULATION REACHES A MAXIMUM FOR THE FENCE AND THE LOGGED FILTER MATERIALS MUST BE REPLACED AS NEEDED OR AS REQUESTED BY THE TOWN.
- ALL EROSION CONTROL STRUCTURES ARE TO REMAIN IN PLACE UNTIL ALL DISTURBED GROUND SURFACES HAVE BEEN STABILIZED EITHER BY PAVING OR RESTORATION OF VEGETATIVE GROUND COVER.
- DE-WATERING WILL NOT BE PERMITTED DURING CONSTRUCTION. SHOULD DE-WATERING BE REQUIRED, A SEPARATE PLAN AND APPROVAL FROM THE GRCA SHALL BE OBTAINED.
- NO ALTERNATIVE METHODS OF EROSION PROTECTION SHALL BE PERMITTED UNLESS APPROVED BY THE DESIGN CONSULTANT AND THE CITY OF GUELPH.
- THE CONTRACTOR IS TO ENSURE THE SILT FENCING IS FUNCTIONING AS INTENDED.
- ANY DAMAGED ESC MEASURES ARE TO BE REPLACED IMMEDIATELY WITHIN 48 HOURS OF INSPECTION.
- SEDIMENT TO BE REMOVED FROM THE SEDIMENT BARRIER ONCE IT HAS REACHED A DEPTH OF 300 mm. ALL ACCUMULATED SEDIMENT SHALL BE REMOVED PRIOR TO REMOVING THE SILT FENCING.
- THE CONTRACTOR IS RESPONSIBLE FOR ENSURING MUNICIPAL ROADWAYS AND SIDEWALKS ARE CLEANED OF ALL SEDIMENTS FROM VEHICULAR TRACKING ETC. TO AND FROM THE SITE AT THE END OF EACH WORKING DAY.
- EROSION AND SEDIMENT CONTROL (ESC) PLAN IS A DYNAMIC DOCUMENT, WHICH MAY BE SUBJECT TO CHANGE OR MODIFICATIONS AS A RESULT OF SITE DEVELOPMENTS OR CHANGES ON SITE. ANY DEVIATION FROM APPROVED PLANS MUST BE DESIGNED BY A QUALIFIED PROFESSIONAL.
- IT IS EVERYONE'S RESPONSIBILITY TO PREVENT CONSTRUCTION RELATED SEDIMENT FROM IMPACTING AQUATIC RESOURCES AND OTHER NATURAL FEATURES.
- NO PUMPING OF SEDIMENT LADEN RUNOFF FROM ONSITE TO THE WETLAND IS ALLOWED AT ANY TIME.
- ALL ACTIVITIES, INCLUDING MAINTENANCE PROCEDURES, WILL BE CONTROLLED TO PREVENT THE ENTRY OF PETROLEUM PRODUCTS, DEBRIS, RUBBLE, CONCRETE, OR OTHER DELETERIOUS SUBSTANCES IN THE WATER. VEHICULAR RE-FUELLING AND MAINTENANCE WILL BE CONDUCTED A MINIMUM OF 30 m FROM THE WATER.
- AN AFTER-HOURS CONTACT NUMBER IS TO BE VISIBLY POSTED ON-SITE FOR EMERGENCIES. ALL THE PLANS SHOULD HAVE NAME AND CONTACT INFO OF THE PERSON RESPONSIBLE FOR ESC MEASURES.
- ANY SEDIMENT SPILL FROM THE SITE SHOULD BE REPORTED TO MINISTRY OF ENVIRONMENT (SPILL ACTION CENTRE) AT 1-800-268-0060.
- ADDITIONAL EROSION AND SEDIMENT CONTROL MATERIALS (IE SILT FENCE, STRAW BALES, CLEAR STONES ... ETC.) ARE TO BE KEPT ON SITE FOR EMERGENCIES AND REPAIRS.

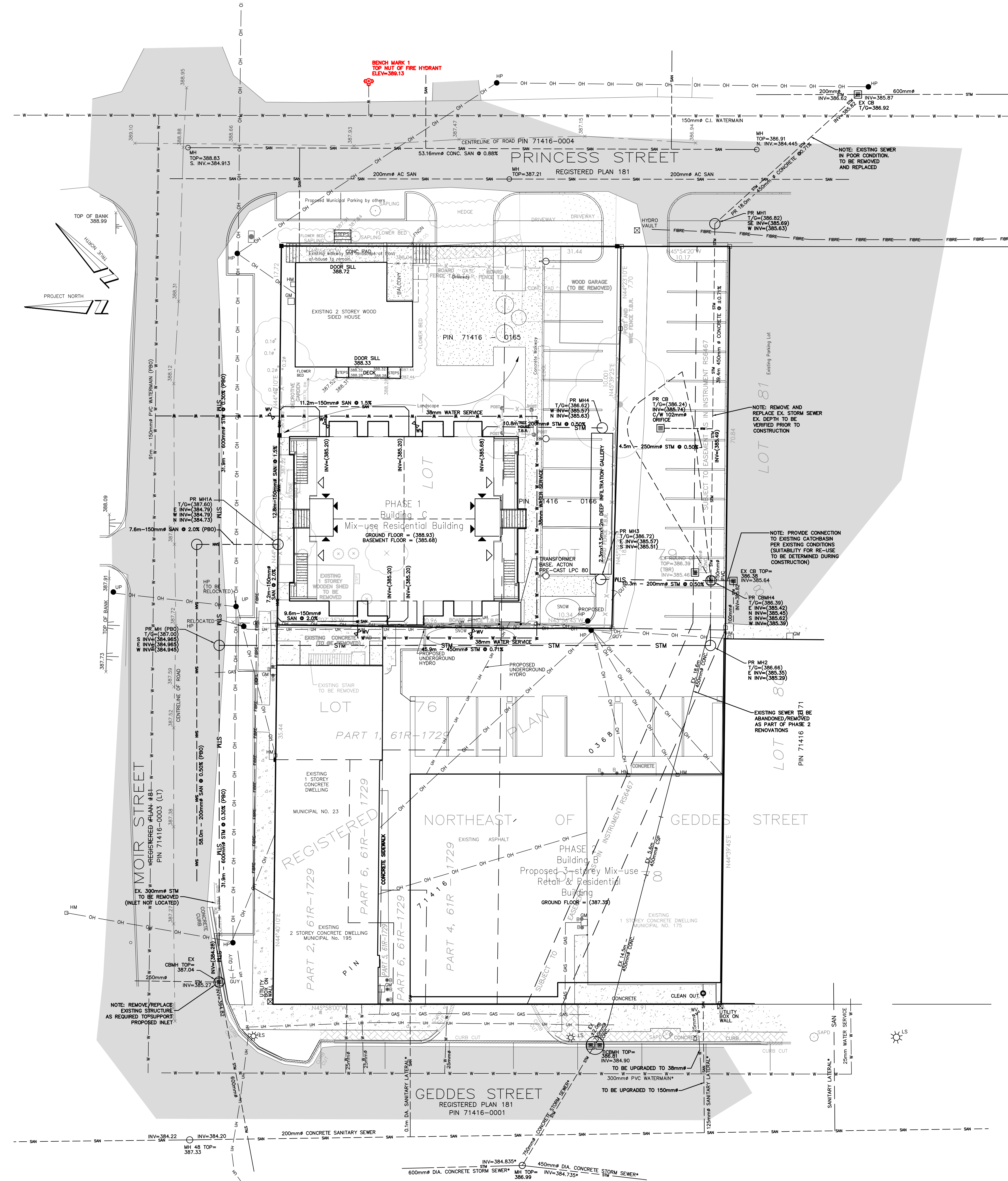

**LEGEND**

	FIBRE		LIGHT STANDARD
	OH		UNDERGROUND FIBRE
	OH		OVERHEAD HYDRO
	OH		UNDERGROUND HYDRO
	GAS		GAS LINE
	GAS		STORM SEWER
	GAS		SANITARY SEWER
	WATERMAIN		FENCE
	VHS PROPOSED GRADE		TRITON PROPOSED GRADE
	SLOPE		DIRECTION OF FLOW
	CENTRELINE OF ROAD		EXISTING ELEVATION
	GUY WIRE		HYDRO POLE
	GAS METER		HYDRO METER
	BELL PEDESTAL		WATER VALVE
	DECIDUOUS TREE		BOLLARD
	DECIDUOUS TREE TO BE REMOVED		SAMPLING
	HYDRO POLE		T.B.R.
	CATCH BASIN		P.B.O.
	MANHOLE		L.A.
	WATER VALVE		EXISTING PAVEMENT
	BOLLARD		EXISTING GRAVEL
	SAMPLING		EXISTING CONCRETE
	T.B.R.		PHASE 1
	P.B.O.		PHASE 2
	L.A.		EXISTING CURB CUT

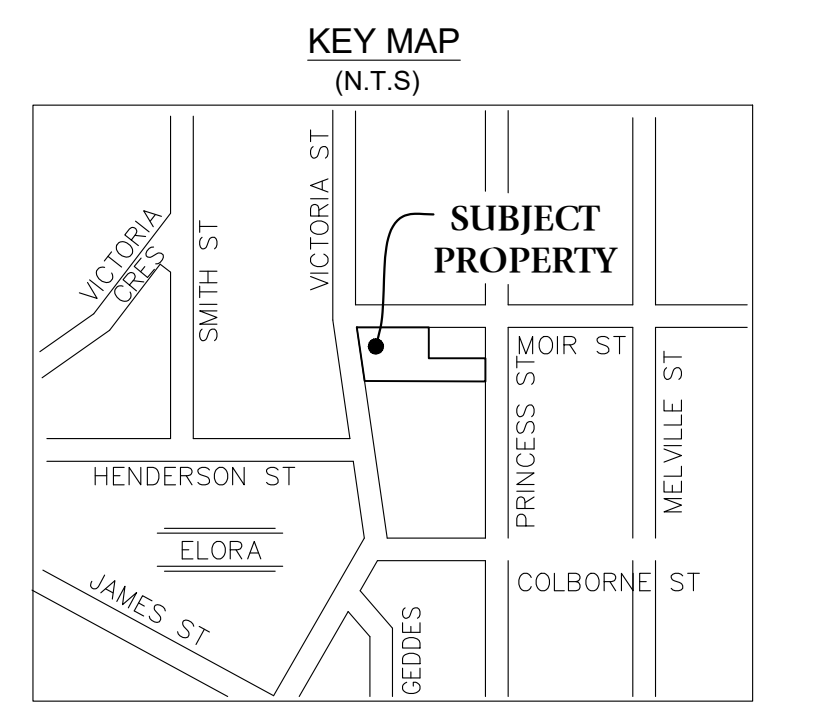

**CAUTION:**  
- THIS IS NOT A PLAN OF SURVEY AND SHALL NOT BE USED FOR TRANSACTION OR MORTGAGE PURPOSES.  
- THIS SKETCH IS PROTECTED BY COPYRIGHT.

**BENCHMARK:**  
ELEVATIONS ARE BASED ON GPS OBSERVATIONS TO PERMANENT REFERENCE STATIONS IN THE NAD83 (CSRS-2010) COORDINATE SYSTEM AND HAVE BEEN CORRECTED TO ORTHOMETRIC ELEVATIONS ON THE CGVD28 DATUM (1978 ADJUSTMENT) WITH GEOID MODEL HTV2.0, AS SUPPLIED BY NATURAL RESOURCES CANADA.  
SITE BENCH MARK 1: TOP NUT OF FIRE HYDRANT, ELEV=389.13m.  
SITE BENCH MARK 2: TOP OF 0.7x0.7 CATCH BASIN, ELEV=386.52m.

**PROPERTY DESCRIPTION:**  
• PIN 71416-0168, PIN 71416-0169, & PIN 71416-0170  
• 23, 175, & 195 GEDDES STREET  
• REGISTERED PLAN 181  
• (GEOGRAPHIC VILLAGE OF ELORA)  
• TOWNSHIP OF CENTRE WELLINGTON  
• COUNTY OF WELLINGTON

**BOUNDARY NOTE:**  
BOUNDARY BEARINGS AND DISTANCES AS PER SURVEYOR'S REAL PROPERTY REPORT BY VAN HARTEN SURVEYING INC., PROJECT 26629-18.

NO.	REVISION	BY	DATE
2	INITIAL SUBMISSION	MAMV	DEC 8-21
1	FOR COORDINATION	MAMV	SEP 21-21

**DRAWING REVISION SCHEDULE**

**LOT DEVELOPMENT PLAN FOR:**  
**23, 175, & 195 GEDDES STREET**  
**ALL OF LOTS 76, & 78**  
**PART OF LOT 79**  
**REGISTERED PLAN 181**  
**TOWNSHIP OF CENTRE WELLINGTON**  
**COUNTY OF WELLINGTON**

PROJECT No. 26629-18  
DRAWING SCALE 1 : 200

**METRIC:**  
DISTANCES SHOWN ON THIS PLAN ARE IN METRES AND CAN BE CONVERTED TO FEET BY DIVIDING BY 0.3048.

**SERVICING: PHASE 2**

SHEET 4 OF 5

PREPARED FOR:  
**DAVE GILLIS**

**Van Harten SURVEYING INC.**  
LAND SURVEYORS AND ENGINEERS

Kitcheener/Waterloo Ph: 519-742-8371  
Guelph Ph: 519-821-2763  
Orangeville Ph: 519-940-4110

www.vanharten.com info@vanharten.com

DRAWN BY: RKH DESIGN BY: MAMV CHECKED BY: MAMV

**CALL BEFORE YOU DIG**  
THE LOCATION OF SERVICES ON THIS DRAWING ARE ONLY APPROXIMATE AND BASED ON SURFACE FEATURES LOCATED AT THE TIME OF THE TOPOGRAPHIC SURVEY. PRIOR TO ANY CONSTRUCTION IT IS THE RESPONSIBILITY OF THE CONTRACTOR/BUILDER TO ENSURE THE EXACT LOCATION OF ALL UTILITIES.

**GENERAL NOTES:**

- PROPOSED GRADING AND ELEVATIONS ARE SUBJECT TO CHANGE PENDING VERIFICATION OF STREET RECONSTRUCTION PLANS OF MOIR STREET (PLANS PREPARED BY OTHERS).
- OPSS AND OPSS STANDARD DRAWINGS CONSTITUTE PART OF THE SPECIFICATIONS STATED ON THIS DRAWING. ALL UNDERGROUND SERVICE MATERIALS AND INSTALLATIONS TO BE IN ACCORDANCE WITH THE LATEST APPLICABLE CODES AND STANDARDS.
- ALL DIMENSIONS AND LOCATIONS OF EXISTING SERVICES TO BE CONFIRMED BY THE CONTRACTOR PRIOR TO COMMENCING ANY CONSTRUCTION PROPOSED BY THIS DRAWING. ANY DISCREPANCIES ARE TO BE REPORTED TO THE PROJECT ENGINEER IMMEDIATELY.
- THE POSITION OF UNDERGROUND SERVICES AND CONDUITS ARE NOT NECESSARILY SHOWN ON THIS DRAWING, AND WHERE SHOWN, THE ACCURACY OF THE POSITION OF SUCH UTILITIES ARE NOT GUARANTEED. PRIOR TO COMMENCING ANY WORK, THE CONTRACTOR WILL INFORM HIMSELF OF THE EXACT LOCATION OF ALL SUCH UTILITIES AND ACCEPT ALL LIABILITY FOR ANY DAMAGE DONE TO THEM.
- THE OWNER IS RESPONSIBLE FOR THE COORDINATION OF ALL REQUIRED UTILITIES. THE OWNER SHALL BE RESPONSIBLE FOR ALL DITCHING, REGRADING AND RESTORATION WORK WITHIN THE TOWNSHIP'S ROAD ALLOWANCE AND TO THE CITY'S SATISFACTION, AS REQUIRED TO ACCOMMODATE THE PROPOSED DEVELOPMENT.
- THE OWNER IS RESPONSIBLE FOR SATISFYING HIMSELF THAT THERE IS ADEQUATE FIRE PROTECTION AVAILABLE FOR HIS PURPOSES.
- ALL ENTRANCE WORK TO MEET THE TOWNSHIP'S SATISFACTION.
- THE PAVEMENT STRUCTURE FOR THE PARKING AREAS SHALL COMPRISE 40mm HL3, 50mm HL8, 150mm GRANULAR 'A' AND 300mm GRANULAR 'B'.
- HEAVY DUTY ASPHALT WITHIN THE FIRE ROUTE SHALL COMPRISE AT MINIMUM 50mm HL3, 60mm HL8, 150mm GRANULAR 'A' AND 450mm GRANULAR 'B'.
- A GEOTECHNICAL CONSULTANT SHOULD BE RETAINED TO CARRY OUT NECESSARY INSPECTIONS AND TESTING DURING PARKING LOT CONSTRUCTION TO ENSURE PLACEMENT OF PROPER MATERIALS AND ADEQUATE COMPACTION.
- SEDIMENT AND EROSION CONTROLS TO BE PROVIDED DURING CONSTRUCTION.
- ENTRANCE PERMIT WILL BE REQUIRED PRIOR TO CONSTRUCTION OF PROPOSED SITE ENTRANCE.
- THE BOULEVARD AREA WITHIN THE ROAD ALLOWANCE THAT IS NOT COVERED WITH ASPHALT OR GRAVEL SHALL BE FINE GRADED AND COVERED WITH A MINIMUM OF 200mm OF TOPSOIL AND SEEDED.
- ALL PARKING GRANULAR MATERIAL SHALL BE COMPACTED TO 100% AND OTHER MISCELLANEOUS FILL MATERIAL BROUGHT TO THE SITE SHALL BE COMPACTED TO 95% PROCTOR (UNLESS OTHERWISE PRESCRIBED BY GEOTECHNICAL INVESTIGATION).
- FILL MATERIAL SHALL BE FREE OF DEBRIS INCLUDING LARGE ROCKS AND STONES. EXCESS DEBRIS AND MATERIAL SHALL BE REMOVED FROM THE SITE.
- ALL LANDSCAPED AREAS ON SITE SHALL BE PROVIDED WITH A MINIMUM OF 150mm OF TOPSOIL AND SEEDED OR SODDED.
- ANY AREAS NOT UNDER ACTIVE CONSTRUCTION SHALL BE STABILIZED WITH TOPSOIL AND SEED.
- PLAN IS BASED IN TOPOGRAPHIC SURVEY COMPLETED BY VAN HARTEN SURVEYING INC. DATED JANUARY 15, 2020.
- THIS IS NOT A PLAN OF SURVEY AND SHALL NOT BE USED FOR TRANSACTION OR MORTGAGE PURPOSES.

**SERVICING NOTES:**

- SERVICING DETAILS SHOWN ON THIS PLAN ARE PRELIMINARY PENDING VERIFICATION OF PROPOSED SERVICING DESIGN OF MOIR STREET (PREPARED BY OTHERS).
- ALL UTILITIES TO BE CONFIRMED BY THE OWNER PRIOR TO CONSTRUCTION.
- ALL SERVICES ARE TO BE INSTALLED TO APPROPRIATE OPSS AND TOWNSHIP OF CENTRE WELLINGTON STANDARDS.
- SANITARY SEWER PIPING TO BE 150mmØ PVC DR 28.
- MANHOLE JOINTS ON ALL SANITARY SEWER CONNECTIONS TO BE WRAPPED TO PREVENT GROUNDWATER INFILTRATION WITH PETROLIUM TAPE.
- ALL STORM SEWERS TO BE PVC PIPE AND CONFORM TO OPSS 1820 AND ANY APPLICABLE CSA STANDARDS.
- ALL CATCHBASINS SHALL BE 600mm x 600mm PRECAST CONCRETE AS PER OPSS 705.010 - TYPE A.
- ALL MANHOLES AND CATCHBASIN MANHOLES SHOWN ON THIS DRAWING TO BE MINIMUM 1200mmØ PRECAST CONCRETE AND CONFORM TO THE APPLICABLE OPSS.
- ALL WATERMANS SHALL BE CONSTRUCTED IN ACCORDANCE WITH OPSS 441.
- ALL MUNICIPAL OWNED WATER VALVES SHALL BE OPERATED BY THE TOWNSHIP. THE CONTRACTOR SHALL COORDINATE ALL NECESSARY VALVE OPERATIONS WITH THE TOWNSHIP PUBLIC WORKS DEPARTMENT.
- WHERE EXISTING WATERMANS ARE TAPPED, THE PIPE SURFACE AT THE LOCATION OF THE TAP SHALL BE CLEANED AND DISINFECTED USING A MINIMUM 1% SODIUM HYPOCHLORITE SOLUTION. WHERE APPLICABLE, THE DRILL/CUTTING/TAPPING BITS AND ALL SURFACES OF MAINSTOPS, SERVICE SADDLES, TAPPING SLEEVES AND VALVES WHICH WILL COME INTO CONTACT WITH DRINKING WATER SHALL LIKEWISE BE CLEANED AND DISINFECTED USING A MINIMUM 1% SODIUM HYPOCHLORITE SOLUTION IMMEDIATELY PRIOR TO INSTALLATION, IF ANY OF THE DISINFECTED SURFACES COME INTO CONTACT WITH THE SOIL AND/OR WATER IN THE EXCAVATION PRIOR TO USE, THE CLEANING AND DISINFECTION PROCEDURE SHALL BE REPEATED.
- THE CONTRACTOR SHALL PROVIDE AND MAINTAIN TEMPORARY WATER SUPPLY TO BUILDINGS AT ALL TIMES. THE CONTRACTOR WILL BE RESPONSIBLE FOR THE QUALITY TESTING OF THE TEMPORARY SUPPLY IN ACCORDANCE WITH TESTING PROCEDURES TO THE SATISFACTION OF THE CENTRE WELLINGTON ENVIRONMENTAL SERVICES DEPARTMENT.
- CONNECTION OF PROPOSED WATERMAIN TO MUNICIPAL WATERMAIN TO BE IN ACCORDANCE WITH TOWNSHIP OF CENTRE WELLINGTON STANDARDS.

**SEDIMENT AND EROSION CONTROL NOTES:**

- ALL SILT FENCING TO BE INSPECTED AND INSTALLED PRIOR TO THE COMMENCEMENT OF ANY GRADING OR EXCAVATING.
- EROSION PROTECTION TO BE PROVIDED AROUND ALL SWALES AND DITCHES.
- ALL PROPOSED AND EXISTING CATCHBASINS AND OTHER UTILITY STRUCTURES TO BE PROVIDED WITH SILT SACS DURING CONSTRUCTION.
- ADDITIONAL EROSION CONTROL MEASURES MAY BE REQUIRED AS SITE DEVELOPMENT PROGRESSES. THE CONTRACTOR IS RESPONSIBLE TO PROVIDE ANY ADDITIONAL EROSION CONTROL STRUCTURES.
- EROSION CONTROL STRUCTURES ARE TO BE MONITORED ON A WEEKLY BASIS, BEFORE AND AFTER SIGNIFICANT RAINFALL EVENTS. ANY DAMAGE TO STRUCTURES REPAIRED IMMEDIATELY. SEDIMENTS ARE TO BE REMOVED WHEN THE HEIGHT OF ACCUMULATION REACHES A MAXIMUM FOR THE FENCE AND THE CLOGGED FILTER MATERIALS MUST BE REPLACED AS NEEDED OR AS REQUESTED BY THE TOWN.
- ALL EROSION CONTROL STRUCTURES ARE TO REMAIN IN PLACE UNTIL ALL DISTURBED GROUND SURFACES HAVE BEEN STABILIZED EITHER BY PAVING OR RESTORATION OF VEGETATIVE GROUND COVER.
- DE-WATERING WILL NOT BE PERMITTED DURING CONSTRUCTION. SHOULD DE-WATERING BE REQUIRED, A SEPARATE PLAN AND APPROVAL FROM THE GRCA SHALL BE OBTAINED.
- NO ALTERNATIVE METHODS OF EROSION PROTECTION SHALL BE PERMITTED UNLESS APPROVED BY THE DESIGN CONSULTANT AND THE CITY OF GUELPH.
- THE CONTRACTOR IS TO ENSURE THE SILT FENCING IS FUNCTIONING AS INTENDED.
- ANY DAMAGED ESC MEASURES ARE TO BE REPLACED IMMEDIATELY WITHIN 48 HOURS OF INSPECTION.
- SEDIMENT TO BE REMOVED FROM THE SEDIMENT BARRIER ONCE IT HAS REACHED A DEPTH OF 300 mm. ALL ACCUMULATED SEDIMENT SHALL BE REMOVED PRIOR TO REMOVING THE SILT FENCING.
- THE CONTRACTOR IS RESPONSIBLE FOR ENSURING MUNICIPAL ROADWAYS AND SIDEWALKS ARE CLEANED OF ALL SEDIMENTS FROM VEHICULAR TRACKING ETC. TO AND FROM THE SITE AT THE END OF EACH WORKING DAY.
- EROSION AND SEDIMENT CONTROL (ESC) PLAN IS A DYNAMIC DOCUMENT, WHICH MAY BE SUBJECT TO CHANGE OR MODIFICATIONS AS A RESULT OF SITE DEVELOPMENTS OR CHANGES ON SITE. ANY DEVIATION FROM APPROVED PLANS MUST BE DESIGNED BY A QUALIFIED PROFESSIONAL.
- IT IS EVERYONE'S RESPONSIBILITY TO PREVENT CONSTRUCTION RELATED SEDIMENT FROM IMPACTING AQUATIC RESOURCES AND OTHER NATURAL FEATURES.
- NO PUMPING OF SEDIMENT LADEN RUNOFF FROM ONSITE TO THE WETLAND IS ALLOWED AT ANY TIME.
- ALL ACTIVITIES, INCLUDING MAINTENANCE PROCEDURES, WILL BE CONTROLLED TO PREVENT THE ENTRY OF PETROLEUM PRODUCTS, DEBRIS, RUBBLE, CONCRETE, OR OTHER DELETERIOUS SUBSTANCES IN THE WATER. VEHICULAR RE-FUELING AND MAINTENANCE WILL BE CONDUCTED A MINIMUM OF 30 m FROM THE WATER.
- AN AFTER-HOURS CONTACT NUMBER IS TO BE VISIBLY POSTED ON-SITE FOR EMERGENCIES. ALL THE PLANS SHOULD HAVE NAME AND CONTACT INFO OF THE PERSON RESPONSIBLE FOR ESC MEASURES.
- ANY SEDIMENT SPILL FROM THE SITE SHOULD BE REPORTED TO MINISTRY OF ENVIRONMENT (SPILL ACTION CENTRE) AT 1-800-268-0960.
- ADDITIONAL EROSION AND SEDIMENT CONTROL MATERIALS (IE SILT FENCE, STRAW BALES, CLEAR STONES ... ETC.) ARE TO BE KEPT ON SITE FOR EMERGENCIES AND REPAIRS.

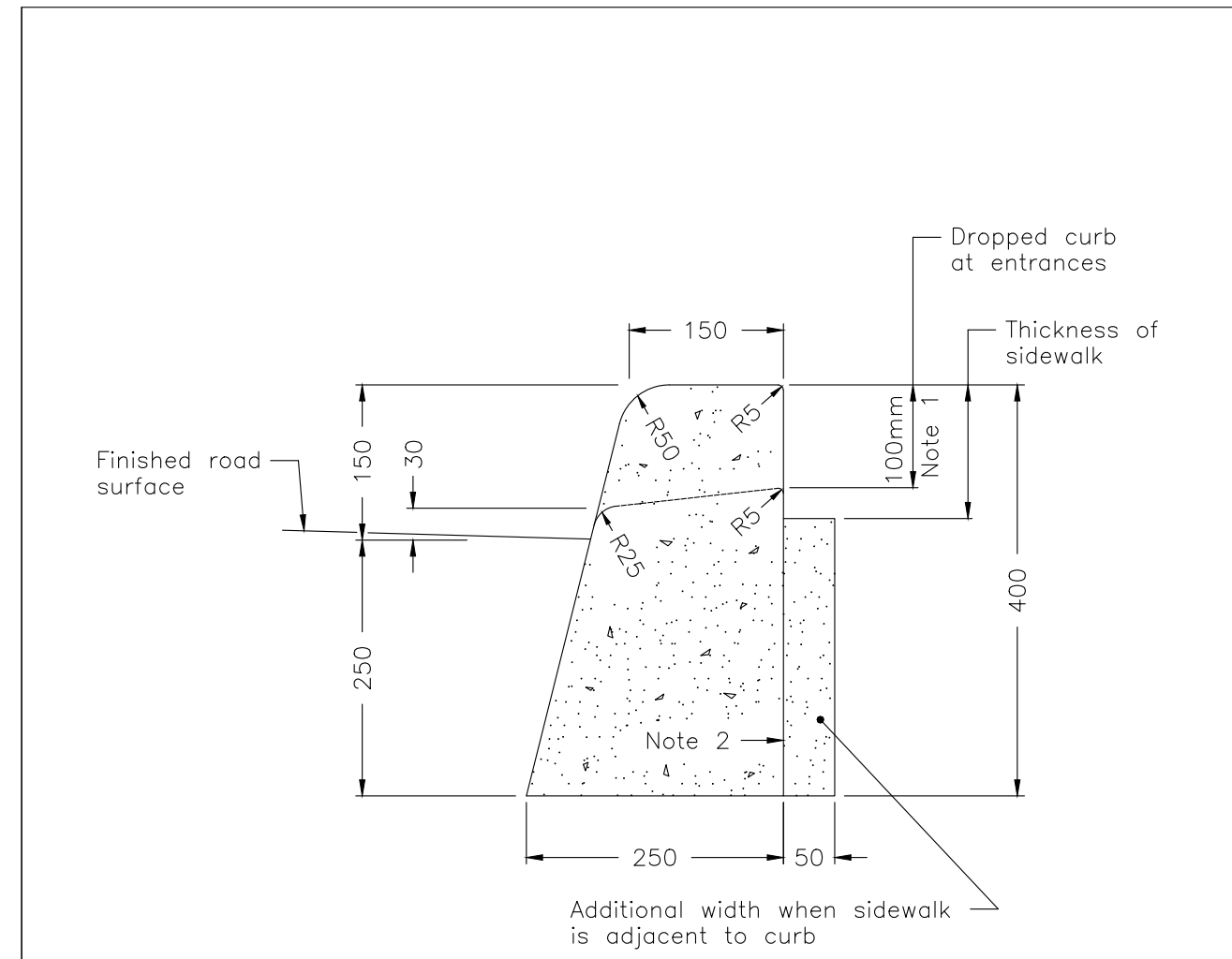

**NOTES:**

- When sidewalk is continuously adjacent, the dropped curb at entrances shall be reduced to 75mm.
- For slipforming procedure a 5% batter is acceptable.
- Treatment at entrances shall be according to OPSS 351.010.
- Outlet treatment shall be according to the OPSS 610 Series.
- The transition from one curb type to another shall be a minimum length of 3.0m, except in conjunction with guide rail where it shall be according to the OPSS 900 Series.
- All dimensions are in millimetres unless otherwise shown.

ONTARIO PROVINCIAL STANDARD DRAWING	Nov 2012	Rev 2	
CONCRETE BARRIER CURB	OPSD 600.110		

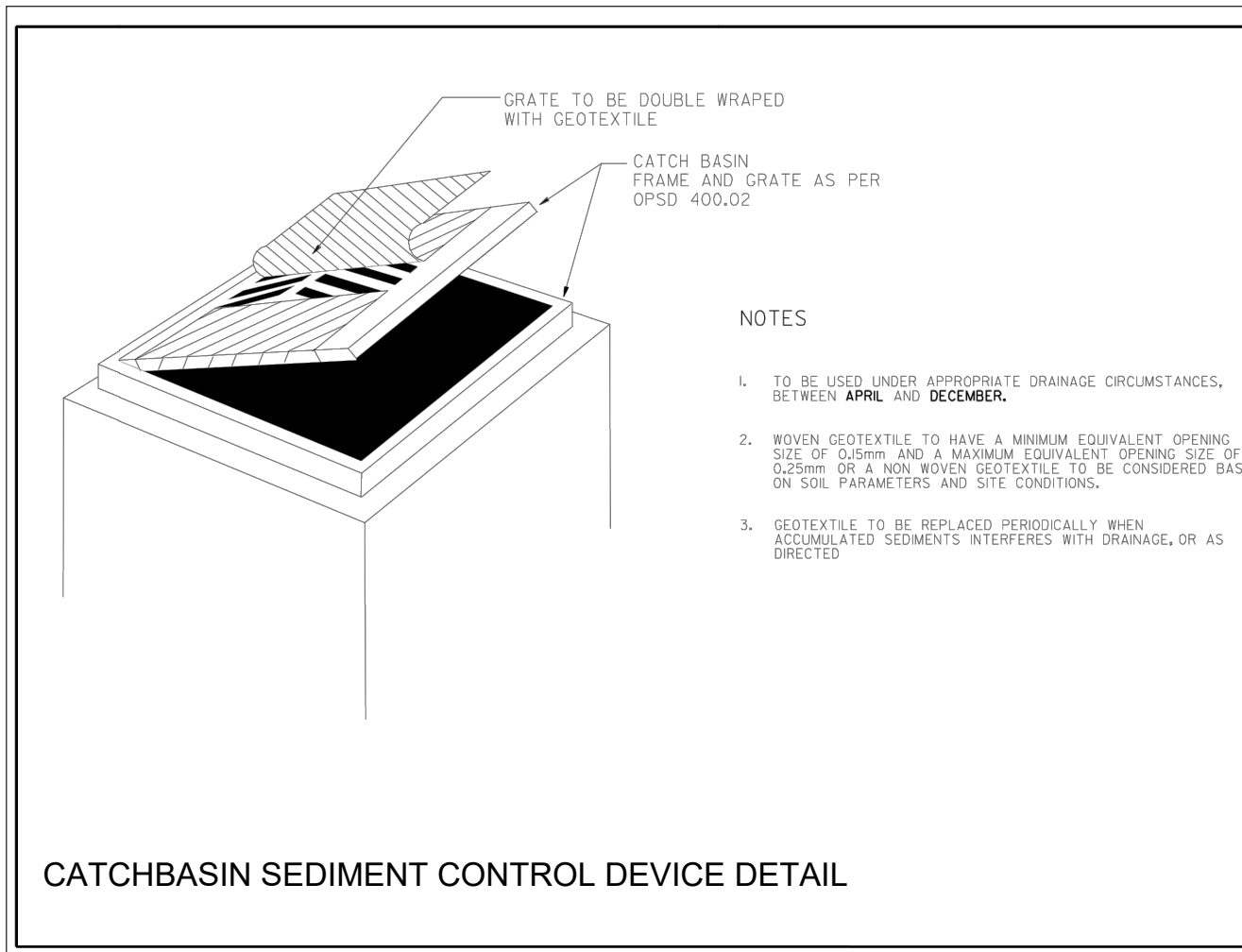

**NOTES:**

- TO BE USED UNDER APPROPRIATE DRAINAGE CIRCUMSTANCES, BETWEEN APRIL AND DECEMBER.
- NON-WOVEN GEOTEXTILE TO HAVE A MINIMUM EQUIVALENT OPENING SIZE OF 500mm AND A MAXIMUM EQUALVALENT OPENING SIZE OF 2500mm OR A NON-WOVEN GEOTEXTILE TO BE CONSIDERED BASED ON SOIL PARAMETERS AND SITE CONDITIONS.
- GEOTEXTILES TO BE REPLACED PERIODICALLY WHEN ACCUMULATED SEDIMENTS INTERFERES WITH DRAINAGE, OR AS DIRECTED.

**TEMPORARY GRAVEL MUD MAT DETAIL**

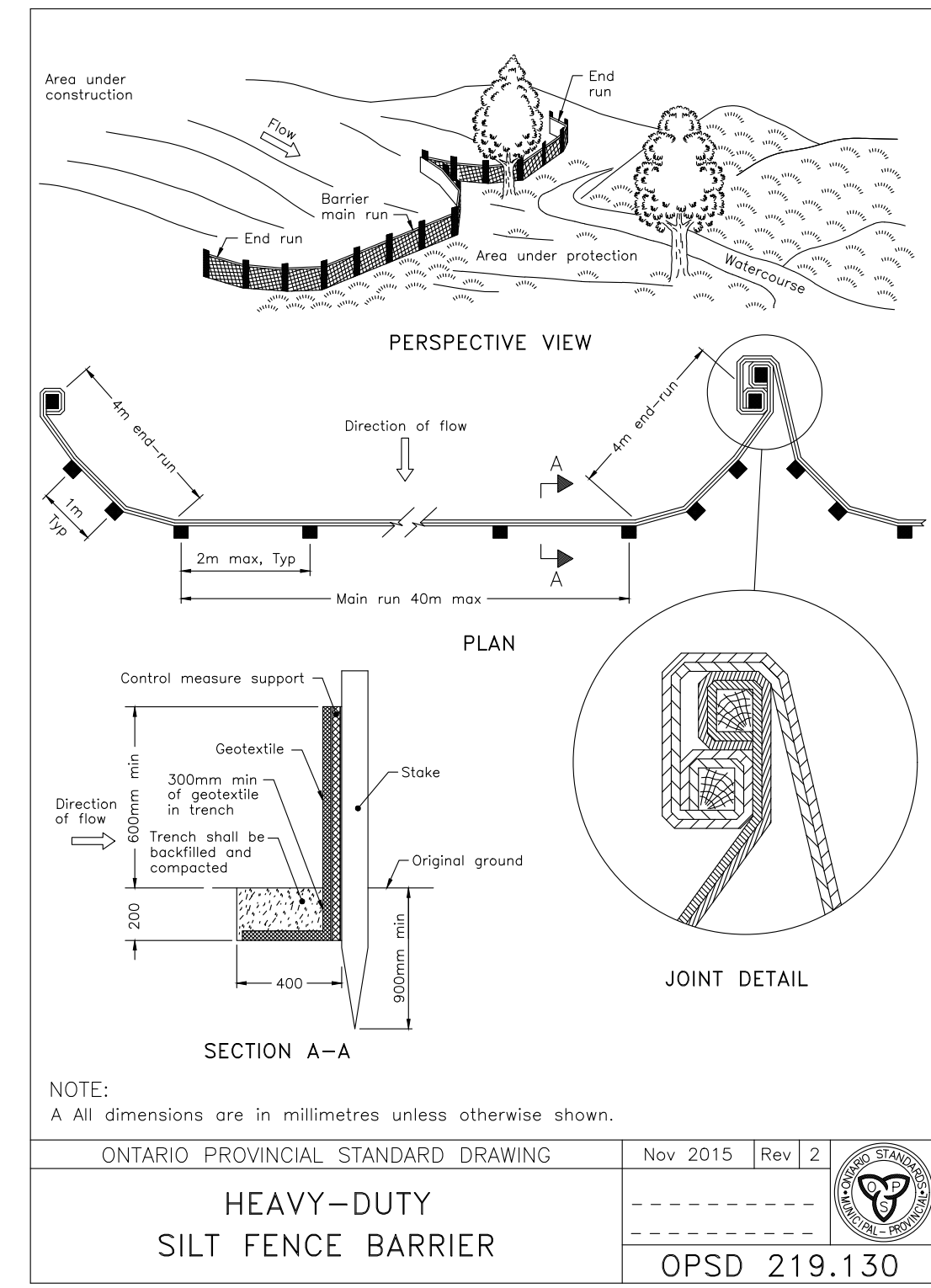
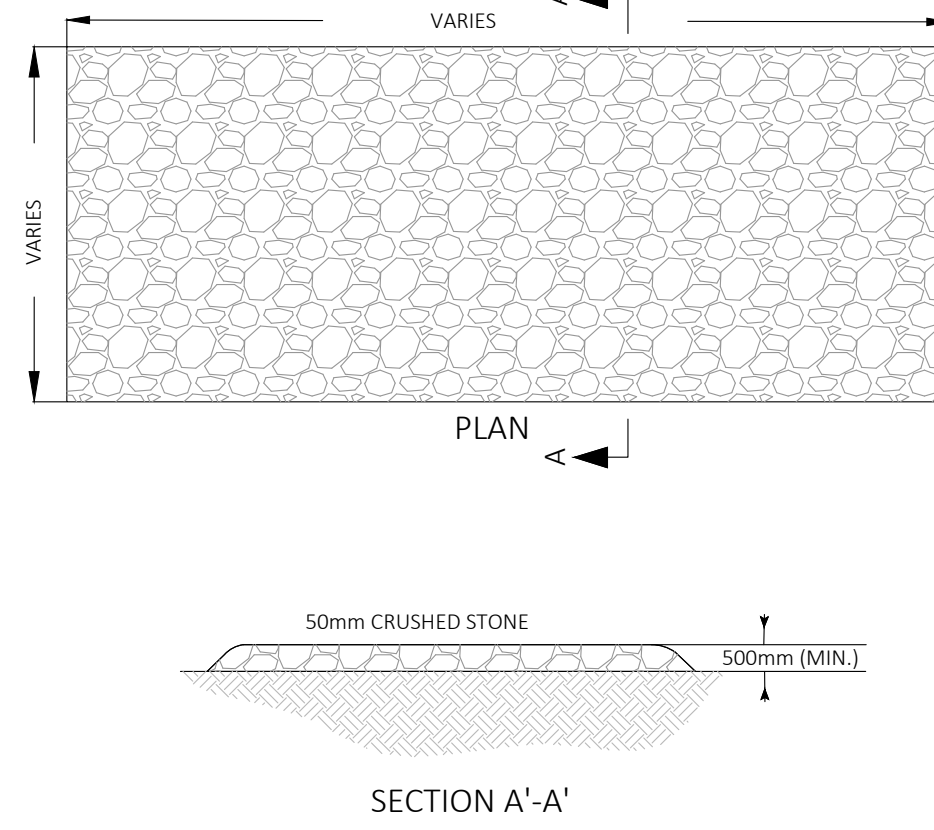

ONTARIO PROVINCIAL STANDARD DRAWING	Nov 2015	Rev 2	
HEAVY-DUTY SILT FENCE BARRIER	OPSD 219.130		

**INFILTRATION GALLERY DETAIL (N.T.S.)**

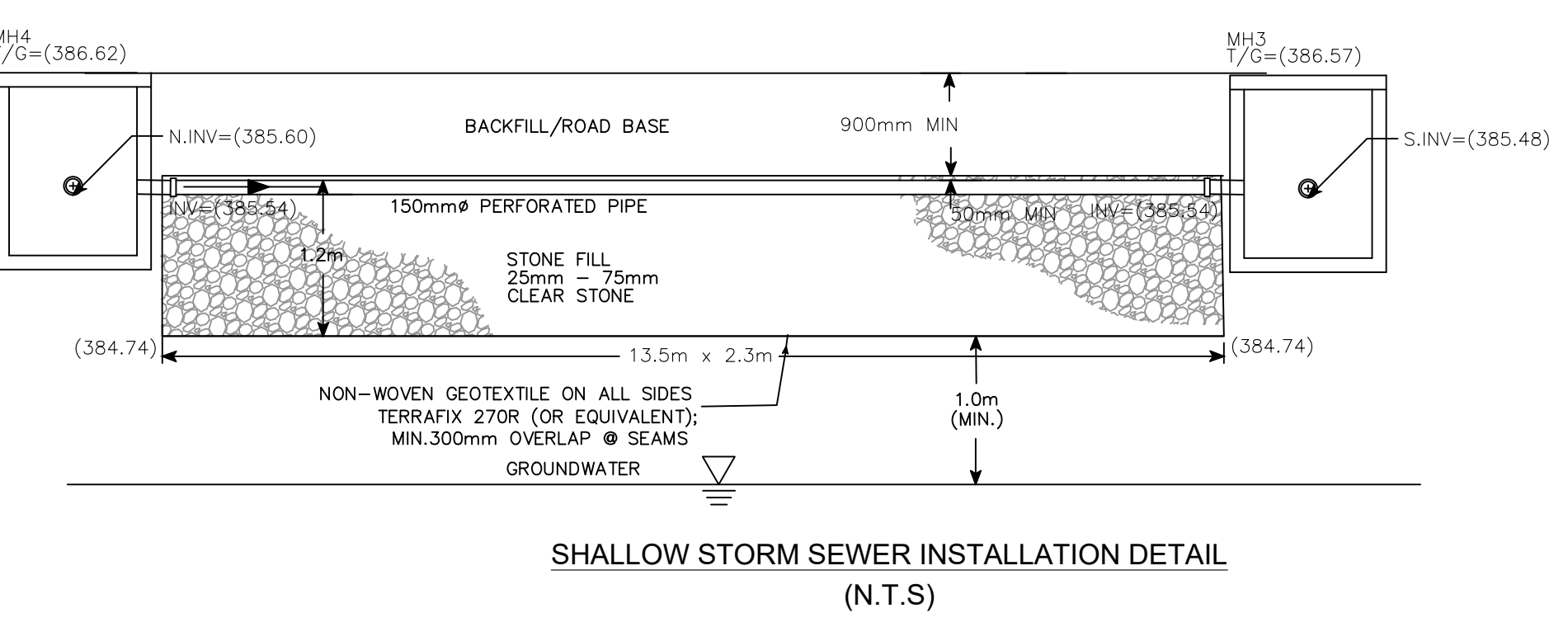

**SHALLOW STORM SEWER INSTALLATION DETAIL (N.T.S.)**

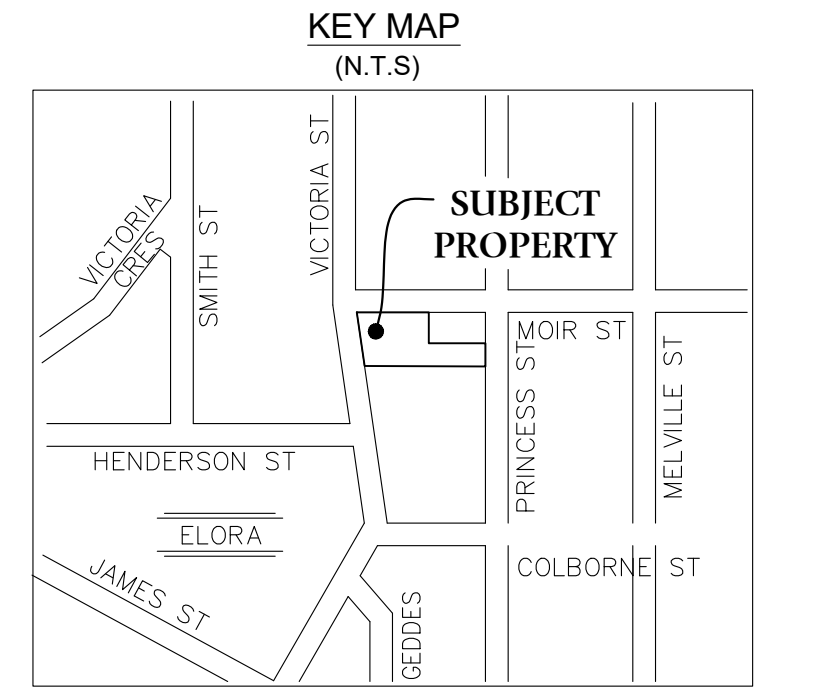
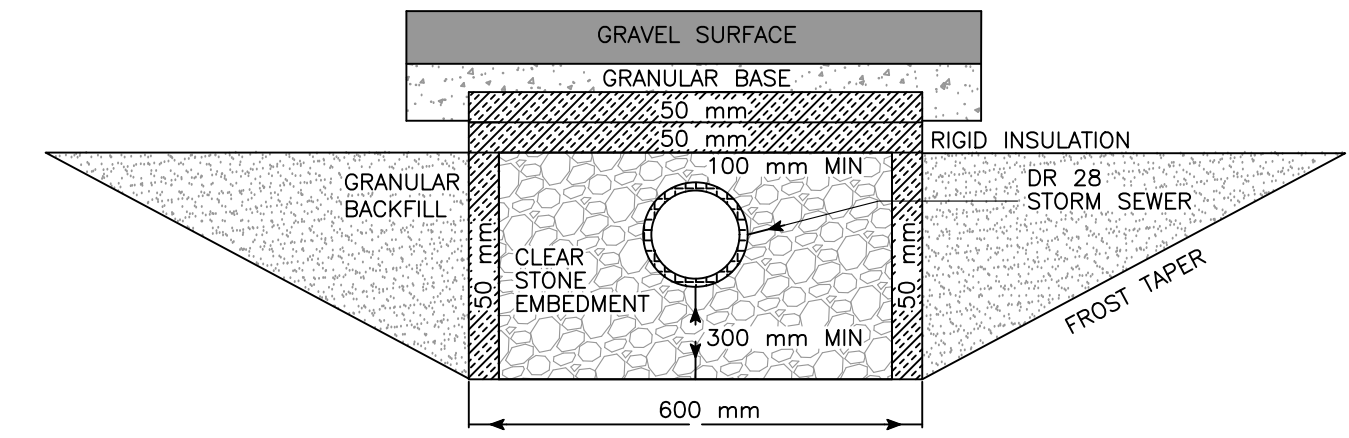

**CAUTION:**  
- THIS IS NOT A PLAN OF SURVEY AND SHALL NOT BE USED FOR TRANSACTION OR MORTGAGE PURPOSES.  
- THIS SKETCH IS PROTECTED BY COPYRIGHT. ©

**BENCHMARK:**  
ELEVATIONS ARE BASED ON GPS OBSERVATIONS TO PERMANENT REFERENCE STATIONS IN THE NAD83 (CSRS-2010) COORDINATE SYSTEM AND HAVE BEEN CORRECTED TO ORTHOMETRIC ELEVATIONS ON THE CGVD28 DATUM (1978 ADJUSTMENT) WITH GEOID MODEL HTV2.0, AS SUPPLIED BY NATURAL RESOURCES CANADA.  
SITE BENCH MARK 1: TOP NUT OF FIRE HYDRANT, ELEV.=389.13m.  
SITE BENCH MARK 2: TOP OF 0.7x0.7 CATCH BASIN, ELEV.=386.52m.

**PROPERTY DESCRIPTION:**  
• PIN 71416-0168, PIN 71416-0169, & PIN 71416-0170  
• 23, 175, & 195 GEDDES STREET  
• REGISTERED PLAN 181  
• (GEOGRAPHIC VILLAGE OF ELORA  
• TOWNSHIP OF CENTRE WELLINGTON  
• COUNTY OF WELLINGTON

**BOUNDARY NOTE:**  
BOUNDARY BEARINGS AND DISTANCES AS PER SURVEYOR'S REAL PROPERTY REPORT BY VAN HARTEN SURVEYING INC., PROJECT 26629-18.

NO.	REVISION	BY	DATE
2	INITIAL SUBMISSION	MAMV	DEC 8-21
1	FOR COORDINATION	MAMV	SEP 21-21

**LOT DEVELOPMENT PLAN FOR:**  
**23, 175, & 195 GEDDES STREET**  
**ALL OF LOTS 76, & 78**  
**PART OF LOT 79**  
**REGISTERED PLAN 181**  
**TOWNSHIP OF CENTRE WELLINGTON**  
**COUNTY OF WELLINGTON**

PROJECT No. 26629-18  
DRAWING SCALE 1 : 200

**METRIC:**  
DISTANCES SHOWN ON THIS SCALE ARE IN METRES AND CAN BE CONVERTED TO FEET BY DIVIDING BY 0.3048.

**DETAILS**

SHEET	
5	
OF	
5	

PREPARED FOR:  
**DAVE GILLIS**

**Van Harten SURVEYING INC.**  
LAND SURVEYORS AND ENGINEERS

Kitchener/Waterloo Ph: 519-742-8371 Guelph Ph: 519-821-2763 Orangeville Ph: 519-940-4110

www.vanharten.com info@vanharten.com

DRAWN BY: RKH DESIGN BY: MAMV CHECKED BY: MAMV

**CALL BEFORE YOU DIG**  
THE LOCATION OF SERVICES ON THIS DRAWING ARE ONLY APPROXIMATE AND BASED ON SURFACE FEATURES LOCATED AT THE TIME OF THE TOPOGRAPHIC SURVEY. PRIOR TO ANY CONSTRUCTION IT IS THE RESPONSIBILITY OF THE CONTRACTOR/BUILDER TO ENSURE THE EXACT LOCATION OF ALL UTILITIES.