

PLANTING MODULE A

SCALE: 1:150

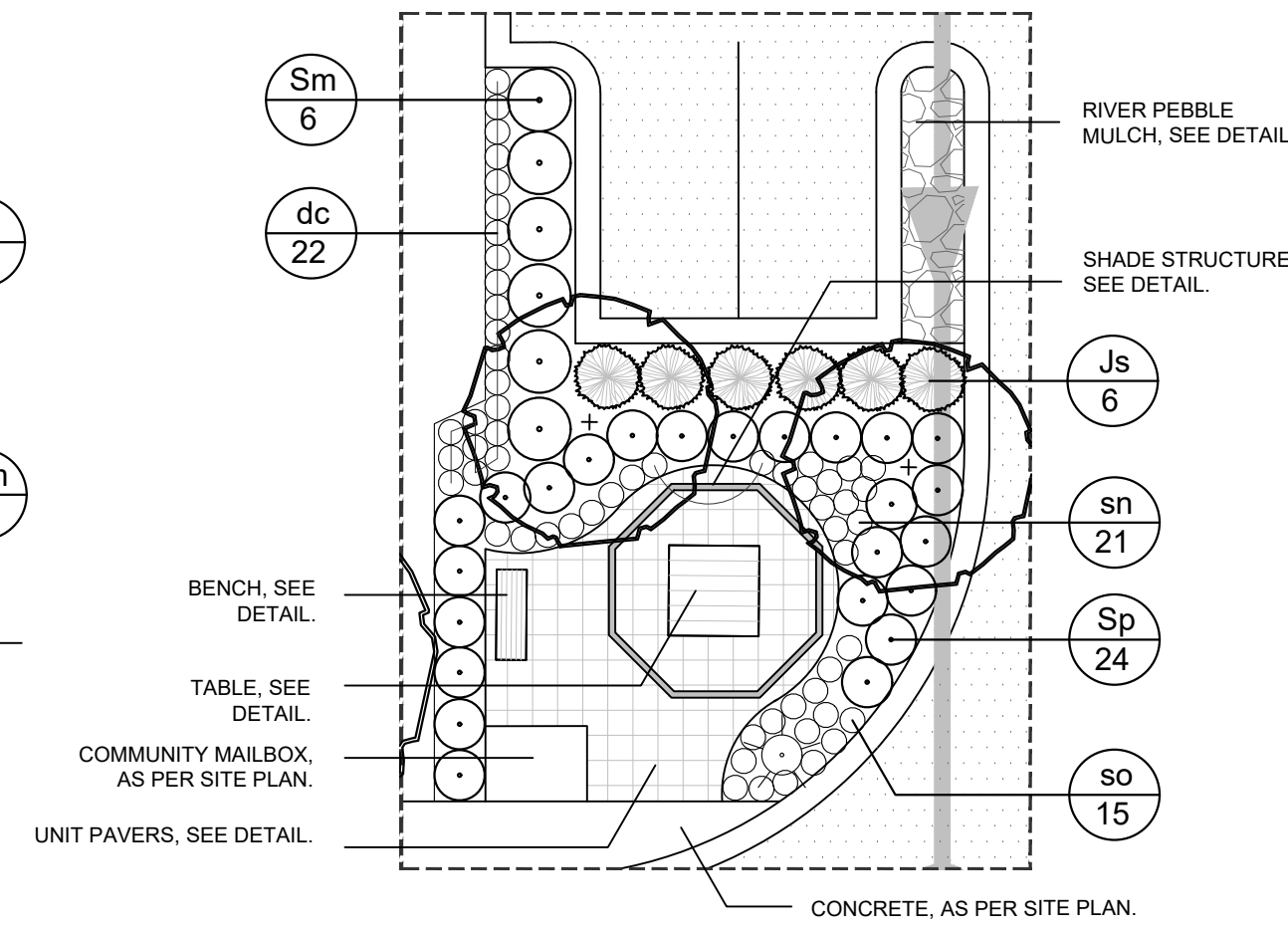

AMENITY AREA ENLARGEMENT

SCALE: 1:150

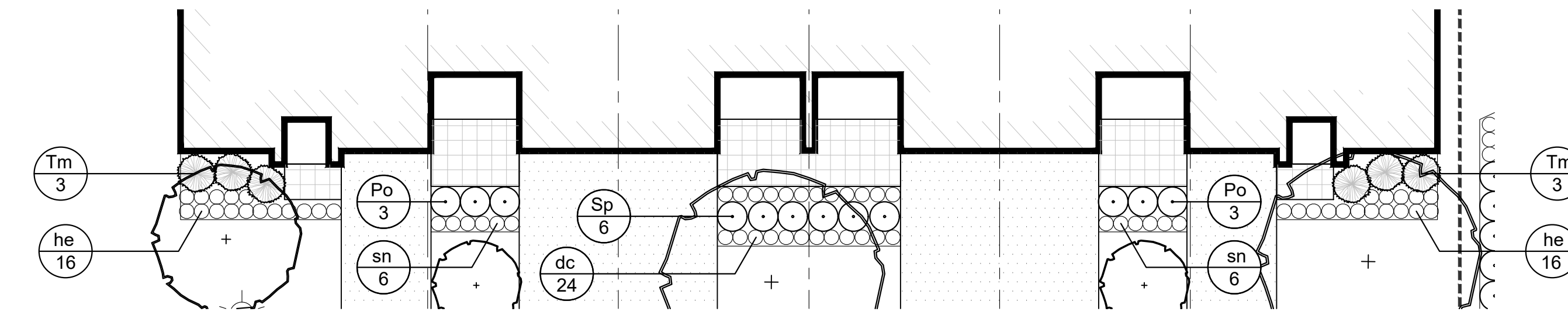

PLANTING MODULE B

SCALE: 1:150

PLANT LIST

KEY	QUANT	BOTANICAL NAME	COMMON NAME	SIZE	COND.
AS	4	Acer saccharum	Sugar Maple	60 mm cal.	W.B.
CJ	3	Cercidiphyllum japonicum	Katsura Tree	60 mm cal.	W.B.
GB	2	Ginkgo biloba	Maidenhair Tree	60 mm cal.	W.B.
GT	3	Gleditsia triacanthos var. inermis	Thornless Honeylocust	60 mm cal.	W.B.
MS	4	Magnolia stellata 'Royal Star' (tree form)	Royal Star Magnolia	10 gal.	Pot
QF	2	Quercus robur 'Fastigiata'	Pyramidal English Oak	60 mm cal.	W.B.
QR	2	Quercus rubra	Red Oak	60 mm cal.	W.B.
TC	3	Tilia cordata	Littleleaf Linden	60 mm cal.	W.B.
TO	18	Thuja occidentalis 'Nigra'	Black Cedar	125 cm / 15 gal.	Pot
Ha	40	Hydrangea arborescens 'Invincible Ruby'	Invincible Ruby Hydrangea	3 gal.	Pot
Js	6	Juniperus sabin	Savin Juniper	3 gal.	Pot
Jm	8	Juniperus sabin 'Moor-Dense'	Moor Dense Juniper	3 gal.	Pot
Pb	12	Physocarpus opulifolius 'Dart's Gold'	Dart's Gold Ninebark	3 gal.	Pot
Sp	36	Salix Purpurea 'Nana'	Blue Arctic Willow	3 gal.	Pot
Sm	6	Syringa meyeri 'Palibari'	Dwarf Korean Lilac	3 gal.	Pot
Tm	52	Taxus x media 'Densiformis'	Dense Yew	3 gal.	Pot
dc	190	Deschampsia cespitosa 'Gold Dew'	Gold Dew Tufted Hair Grass	1 gal.	Pot
he	101	Hemerocallis 'Elegant Candy'	Elegant Candy Day Lily	1 gal.	Pot
sn	45	Salvia nemorosa 'Blue Hill'	Blue Hill Meadow Sage	1 gal.	Pot
so	15	Sorghastrum nutans 'Sioux Blue'	Sioux Blue Indian Grass	1 gal.	Pot

LEGEND

- PROPOSED DECIDUOUS TREE
- PROPOSED DECIDUOUS SHRUB
- PROPOSED CONIFEROUS SHRUB
- PROPOSED GRASS / PERENNIAL
- PROPOSED ASPHALT, AS PER SITE PLAN
- PROPOSED UNIT PAVERS, SEE DETAIL
- HYDROSEED, SEE DETAIL ON L2.
- PROPOSED SUBMERGENT VEGETATION
- PROPOSED EMERGENT VEGETATION
- PROPOSED SHORELINE FRINGE VEGETATION
- LIGHTING

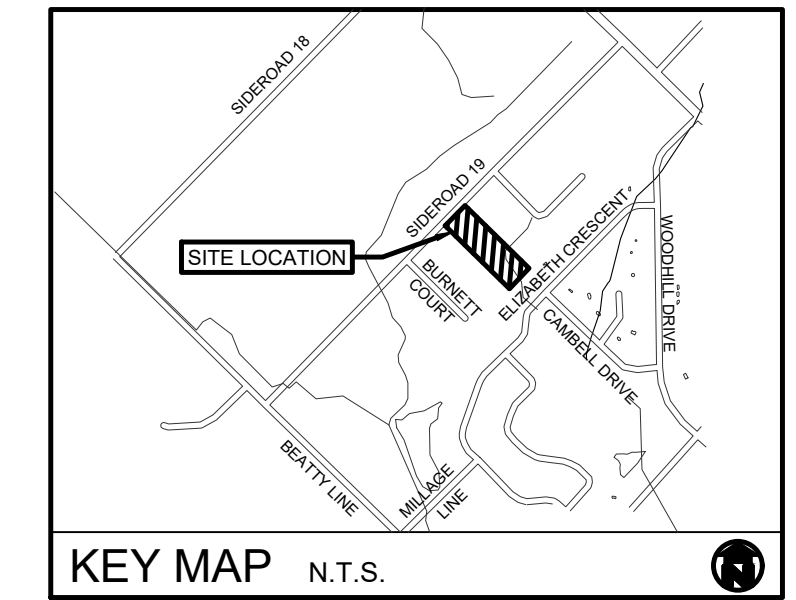

KEY MAP N.T.S.

GENERAL NOTES

1. ALL WORKMANSHIP WILL BE TO THE STANDARDS OF LANDSCAPE ONTARIO.
2. ALL PLANT MATERIAL TO BE NO.1 GRADE NURSERY GROWN IN ACCORDANCE WITH THE CANADIAN STANDARDS FOR NURSERY STOCK, 5TH EDITION, 2017, BY THE CANADIAN NURSERY TRADES ASSOCIATION.
3. BACKFILL WILL CONSIST OF SOIL NATIVE TO THE SITE OR GENERAL SOIL TYPE/CLASS NATIVE TO THE SITE. TOPSOIL TO BE TESTED FOR NUTRIENT VALUE, AND AMENDED FOR OPTIMAL GROWTH AS PER THE RECOMMENDATIONS OF THE SOIL TEST.
4. CONTRACTOR SHALL MAINTAIN ALL LANDSCAPE AREAS UNTIL OWNER'S ACCEPTANCE OF PROJECT.
5. CONTRACTOR TO LOCATE ALL UNDERGROUND UTILITIES.
6. PLANTING MAY BE ADJUSTED TO SUIT LOCATIONS OF SITE UTILITY STRUCTURES/SERVICES.
7. ALL MATERIALS MUST BE APPROVED BY LANDSCAPE ARCHITECT PRIOR TO INSTALLATION.
8. SPREAD MULCH TO A MINIMUM OF 100mm COMPACTED DEPTH ON ALL TREE PITS AND PLANTING BEDS.
9. CHECK AND VERIFY ALL DIMENSIONS AND QUANTITIES PRIOR TO COMMENCEMENT OF WORK. ANY DISCREPANCIES ARE TO BE REPORTED IN WRITING TO THE LANDSCAPE ARCHITECT. QUANTITIES NOTED WITHIN THE PLAN SUPERCEDE THOSE IN THE PLANT LIST. ANY SUBSTITUTIONS SHALL BE APPROVED BY THE LANDSCAPE ARCHITECT.
10. SOD AS MARKED WITH NURSERY SOD ON A MINIMUM OF 100mm OF CLEAN TOPSOIL. FINE GRADE AND SOD ALL BOULEVARD AREAS TO MUNICIPAL SPECIFICATIONS AND REPAIR DAMAGE TO ADJACENT PROPERTIES, AS REQUIRED.
11. FINAL INSPECTION AND ACCEPTANCE OF PLANTING WORK SHALL COINCIDE WITH THE FINAL INSPECTION AND ACCEPTANCE OF ALL WORK INCLUDED IN THE CONTRACT.
12. ALL SEEDED SLOPES 3:1 AND GREATER TO RECEIVE EROSION CONTROL MATTING. PIN SOD ON ALL SLOPES OF 3:1 OR GREATER.
13. SUBMIT A WRITTEN GUARANTEE TO THE EFFECT THAT ALL PLANTS ACCEPTED DURING THE PERIOD OF JANUARY 1st TO JULY 15th SHALL BE GUARANTEED UNTIL JULY 15th THE FOLLOWING YEAR. PLANTS ACCEPTED DURING THE PERIOD OF JULY 15th TO DECEMBER 31st SHALL BE GUARANTEED FOR ONE YEAR FROM THE DATE OF ACCEPTANCE. THE GUARANTEE PERIODS LISTED ABOVE SHALL APPLY TO ALL "NURSERY GROWN" PLANTS.
14. AT THE TIME OF FINAL INSPECTION ALL PLANTS SHALL BE IN A HEALTHY, VIGOROUS GROWING CONDITION, PLANTED IN FULL ACCORDANCE WITH DRAWINGS AND CONDITIONS.
15. SITE PLAN INFORMATION AS PER GSP GROUP.
16. ENGINEERING AS PER GEL AND IS PROVIDED FOR INFORMATION ONLY.
17. SITE LIGHTING BY OTHERS

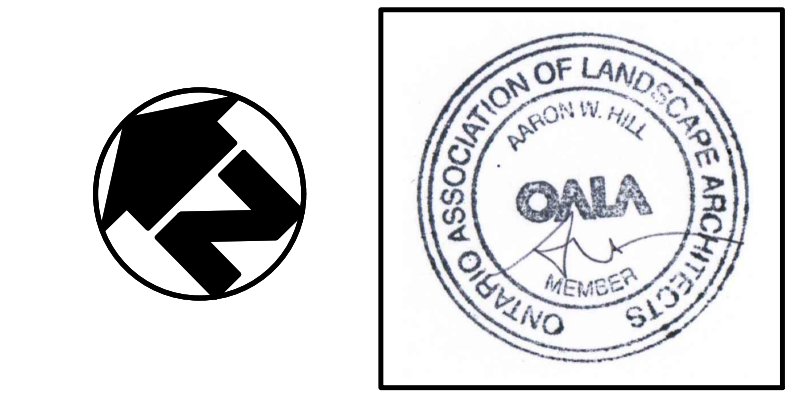
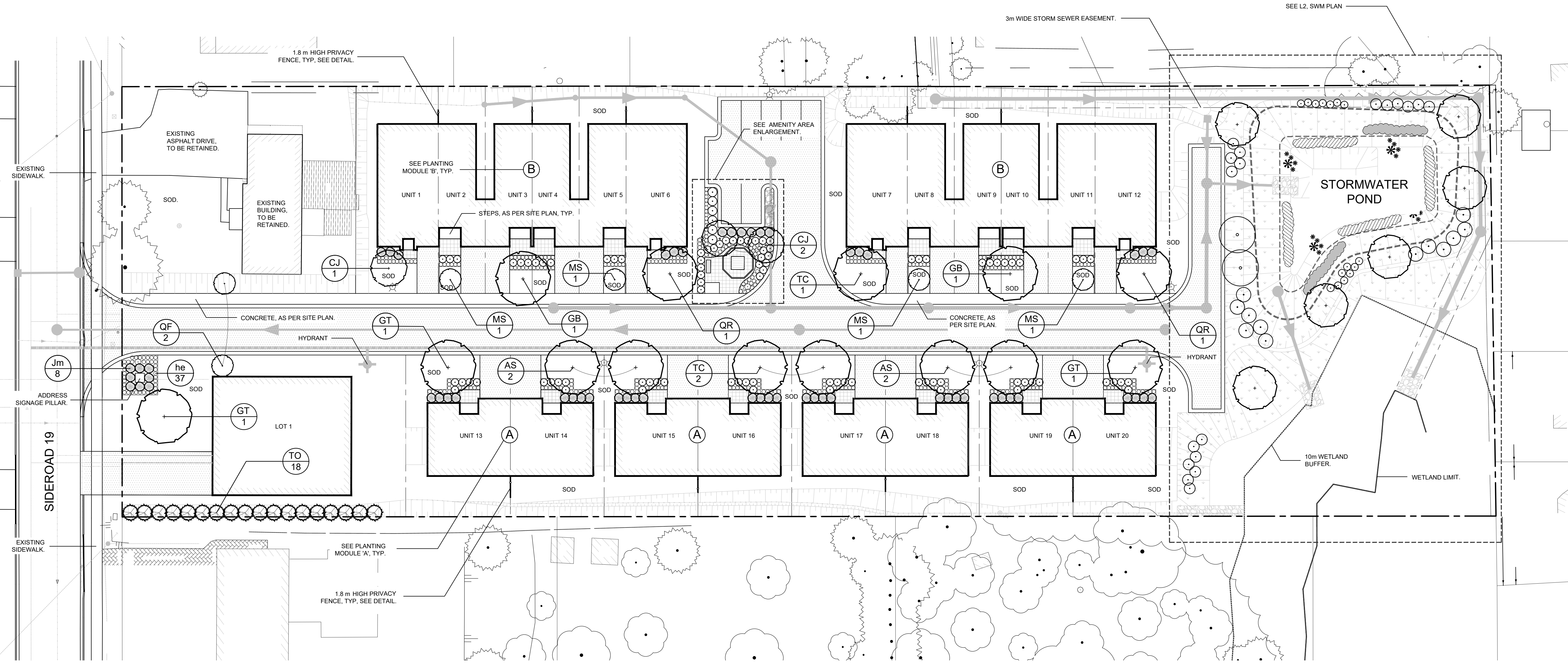

no.	date	description	by
1.	Nov. 8, 2024	ISSUED FOR APPROVAL	JC

Wright Haven Homes  
79 Sideroad 19  
Fergus  
Landscape Plan



PROJECT NO: 2024-75	DRAWN BY: JC
SCALE: 1:300	DESIGNED BY: JC
SHEET: L1	APPROVED BY: AWH
	PLOT DATE: Nov/8/2024

F:\AUTO\_DRAWING\XXXXXX.dwg

**LEGEND**

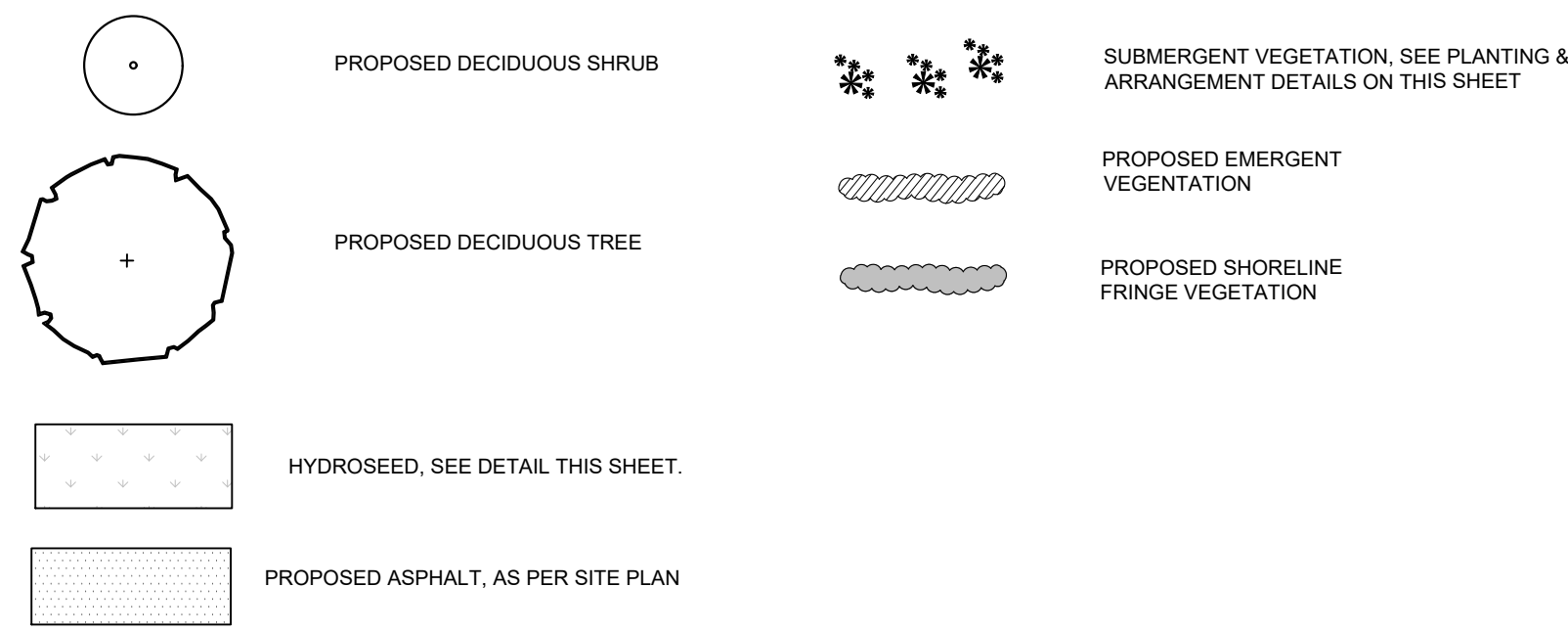

**PLANT MATERIAL LIST**

KEY	QUANT.	BOTANICAL NAME	COMMON NAME	SIZE	COND.
AR	2	Acer rubrum	Red Maple	45mm cal.	W.B.
CA	1	Carya ovata	Shagbark Hickory	45mm cal.	W.B.
LT	1	Liriodendron tulipifera	Tulip Tree	45mm cal.	W.B.
TA	2	Tilia americana	Basswood	45mm cal.	W.B.
Ca	2	Cornus alternifolia	Pagoda Dogwood	50cm, 3 gal.	Pot
Cs	13	Cornus sericea	Red Osier Dogwood	50cm, 3 gal.	Pot
Sa	15	Spiraea alba	Meadowweet	50cm, 3 gal.	Pot
Sc	12	Sambucus canadensis	American Elder	50cm, 3 gal.	Pot
Sl	5	Spiraea latifolia	Steeplebush	50cm, 3 gal.	Pot
<b>Shoreline Fringe Vegetation (extended detention areas)</b>					
cc	44	Calamagrostis canadensis	Blue Joint Grass	Plug	
sa	44	Scirpus atrovirens	Dark-Green Bulrush	Plug	
<b>Emergent Vegetation (less than 0.5m water depth)</b>					
sl	88	Sagittaria latifolia	Arrowhead	Plug	
tl	88	Typha latifolia/angustifolia	Cattail	Plug	
<b>Submergent Vegetation</b>					
ec	8	Elodea canadensis	Water-weed	Bare root	
no	4	Nymphaea odorata	Fragrant Water-lily	Bare root	
pp	8	Potamogeton pectinatus	Sago Pondweed	Bare root	

ALL DISTURBED AREAS TO BE RESTORED WITH 150MM TOPSOIL AND HYDROSEED MIX

NOTE: HYDROSEED MIXES AS PER OSC (PHONE) 1-800-465-5849

NOTE: HYDROSEED SWM POND MIX NOT TO BE INSTALLED BELOW PERMANENT POOL LEVEL AS PER ENGINEERING

**HYDROSEED FOR SWM POND**

**SWM POND MIX WET/DRY MIX (#8245)**

- 3% BLACK EYED SUSAN (RUDBECKIA HIRTA)
- 20% CANADIAN WILD RYE (ELYMUS CANADENSIS)
- 17% FOX SEDGE (CAREX VULPINOIDEA)
- 15% INDIAN GRASS (SORGHASTRUM NUTANS)
- 3% NEW ENGLAND ASTER (ASTER NOVAE-ANGLIAE)
- 1% SPOTTED JOE PYE WEED (EUPATORIUM MACULATUM)
- 20% SWITCHGRASS (Panicum VIRGATUM)
- 20% VIRGINIA WILD RYE (ELYMUS VIRGINICUS)
- 1% WILD BERGAMOT (MONARDA FISTULOSA)

TO BE APPLIED AT A RATE OF 25kg/ha

**ANNUAL RYE GRASS (NURSE CROP)**

- 100% ANNUAL RYE GRASS (LOLIUM MULTIFLORUM)

TO BE APPLIED AT A RATE OF 22kg/ha

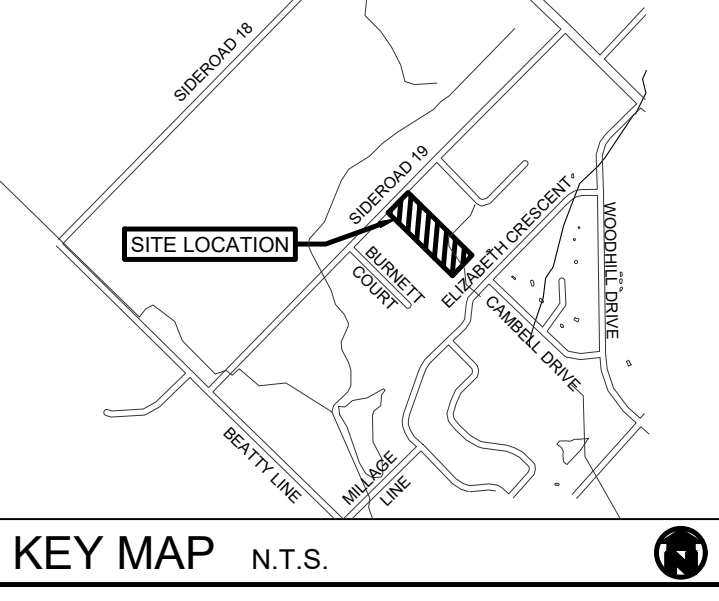
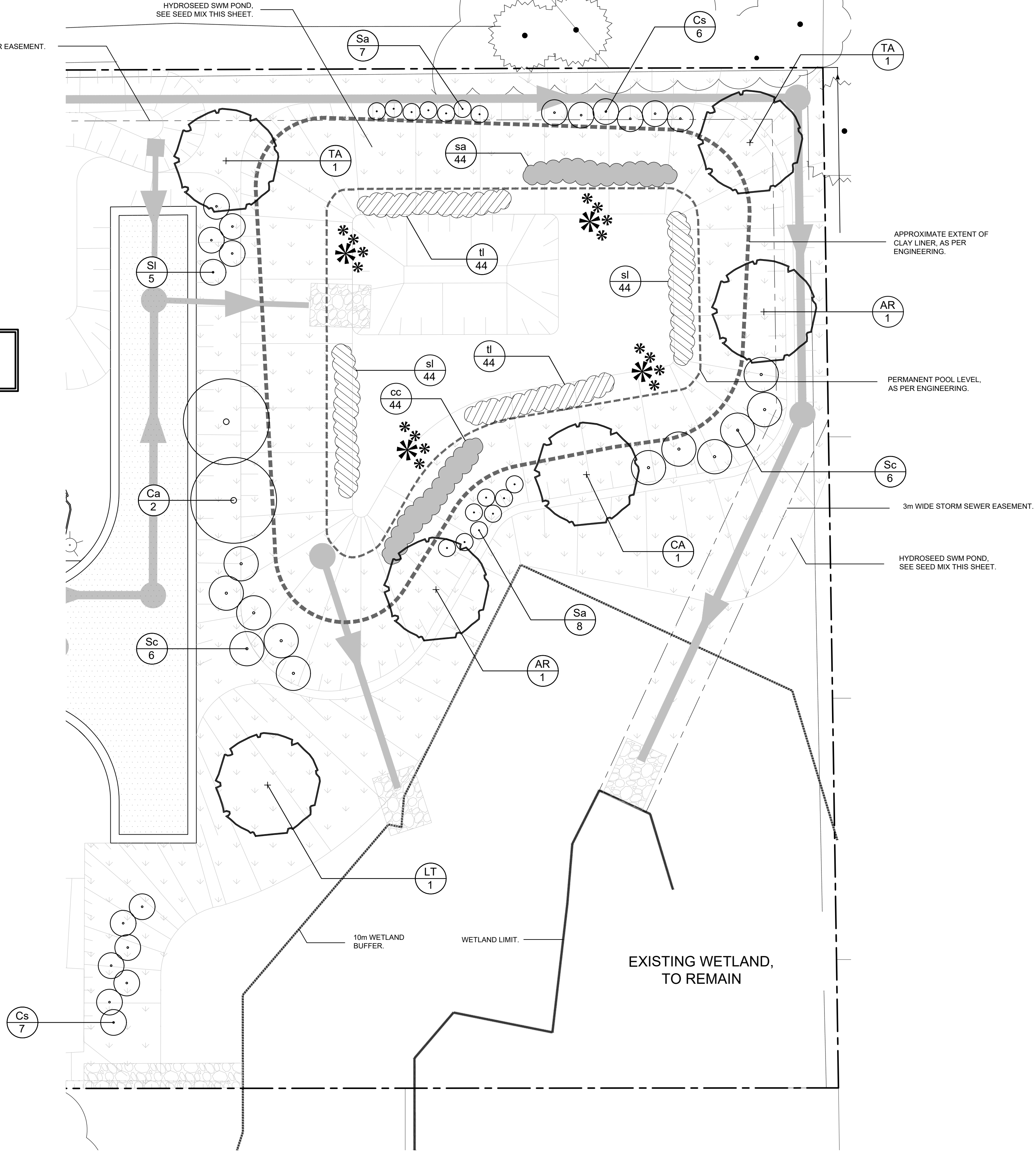
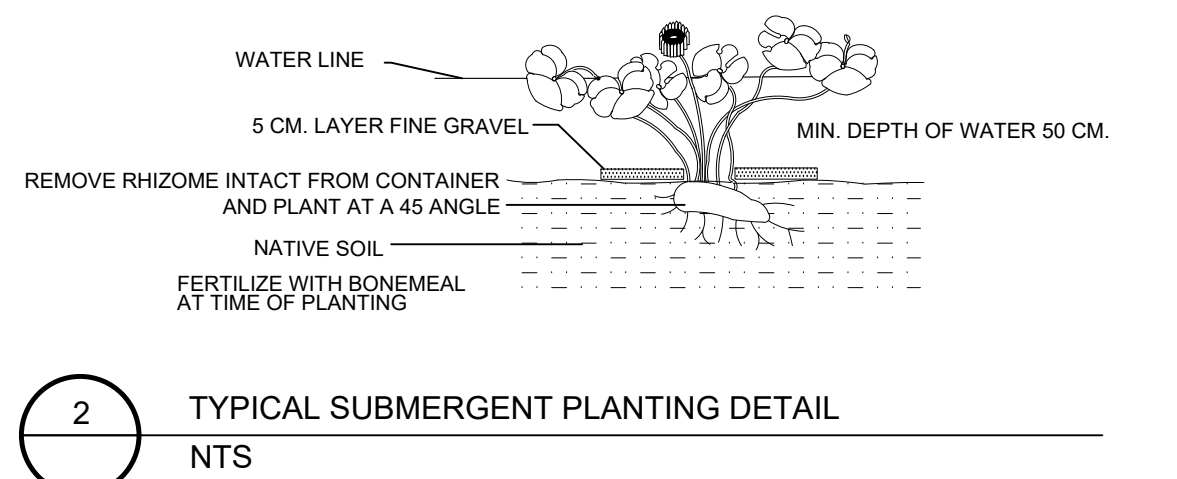
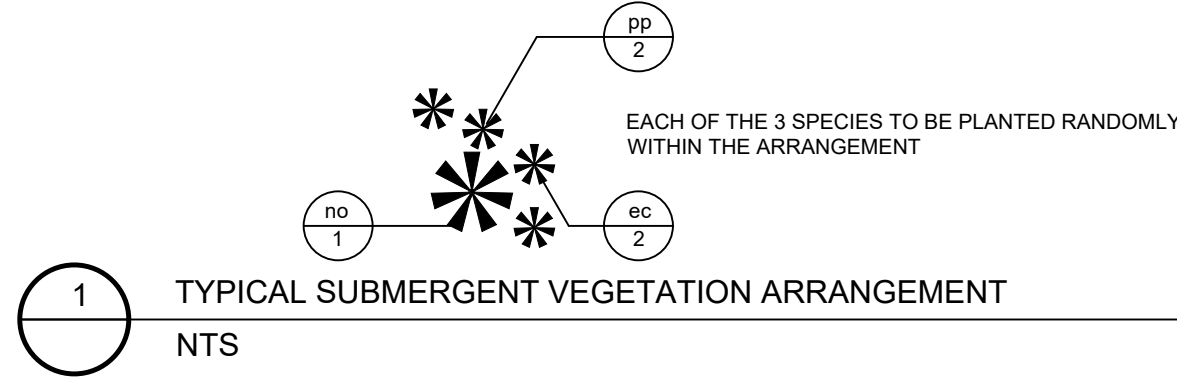

**GENERAL NOTES**

- ALL WORKMANSHIP WILL BE TO THE STANDARDS OF LANDSCAPE ONTARIO.
- ALL PLANT MATERIAL TO BE NO.1 GRADE NURSERY GROWN IN ACCORDANCE WITH THE CANADIAN STANDARDS FOR NURSERY STOCK, 5TH EDITION, 2017, BY THE CANADIAN NURSERY TRADES ASSOCIATION.
- BACKFILL WILL CONSIST OF SOIL NATIVE TO THE SITE OR GENERAL SOIL TYPE/CLASS NATIVE TO THE SITE. TOPSOIL TO BE TESTED FOR NUTRIENT VALUE, AND AMENDED FOR OPTIMAL GROWTH AS PER THE RECOMMENDATIONS OF THE SOIL TEST.
- CONTRACTOR SHALL MAINTAIN ALL LANDSCAPE AREAS UNTIL OWNER'S ACCEPTANCE OF PROJECT.
- CONTRACTOR TO LOCATE ALL UNDERGROUND UTILITIES.
- PLANTING MAY BE ADJUSTED TO SUIT LOCATIONS OF SITE UTILITY STRUCTURES/SERVICES.
- ALL MATERIALS MUST BE APPROVED BY LANDSCAPE ARCHITECT PRIOR TO INSTALLATION.
- SPREAD MULCH TO A MINIMUM OF 100mm COMPACTED DEPTH ON ALL TREE PITS AND PLANTING BEDS.
- CHECK AND VERIFY ALL DIMENSIONS AND QUANTITIES PRIOR TO COMMENCEMENT OF WORK. ANY DISCREPANCIES ARE TO BE REPORTED IN WRITING TO THE LANDSCAPE ARCHITECT. QUANTITIES NOTED WITHIN THE PLAN SUPERCEDE THOSE IN THE PLANT LIST. ANY SUBSTITUTIONS SHALL BE APPROVED BY THE LANDSCAPE ARCHITECT.
- SOD AS MARKED WITH NURSERY SOD ON A MINIMUM OF 100mm OF CLEAN TOPSOIL. FINE GRADE AND SOD ALL BOULEVARD AREAS TO MUNICIPAL SPECIFICATIONS AND REPAIR DAMAGE TO ADJACENT PROPERTIES, AS REQUIRED.
- FINAL INSPECTION AND ACCEPTANCE OF PLANTING WORK SHALL COINCIDE WITH THE FINAL INSPECTION AND ACCEPTANCE OF ALL WORK INCLUDED IN THE CONTRACT.
- ALL SEEDED SLOPES 3:1 AND GREATER TO RECEIVE EROSION CONTROL MATTING. PIN SOD ON ALL SLOPES OF 3:1 OR GREATER.
- SUBMIT A WRITTEN GUARANTEE TO THE EFFECT THAT ALL PLANTS ACCEPTED DURING THE PERIOD OF JANUARY 1st TO JULY 15th SHALL BE GUARANTEED UNTIL JULY 15th THE FOLLOWING YEAR. PLANTS ACCEPTED DURING THE PERIOD OF JULY 15th TO DECEMBER 31st SHALL BE GUARANTEED FOR ONE YEAR FROM THE DATE OF ACCEPTANCE. THE GUARANTEE PERIODS LISTED ABOVE SHALL APPLY TO ALL "NURSERY GROWN" PLANTS.
- AT THE TIME OF FINAL INSPECTION ALL PLANTS SHALL BE IN A HEALTHY, VIGOROUS GROWING CONDITION, PLANTED IN FULL ACCORDANCE WITH DRAWINGS AND CONDITIONS.
- SITE PLAN INFORMATION AS PER GSP GROUP.
- ENGINEERING AS PER GEL AND IS PROVIDED FOR INFORMATION ONLY.
- SITE LIGHTING BY OTHERS

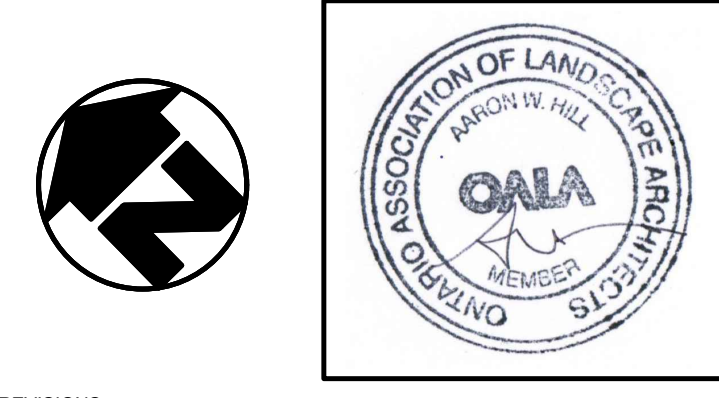

REVISIONS

no.	date	description	by
1.	Nov.8.2024	ISSUED FOR APPROVAL	JC

Wrightshaven Homes  
79 Sideroad 19  
Fergus  
SWM Plan



PROJECT NO: 2024-75	DRAWN BY: JC
SCALE: 1:150	DESIGNED BY: JC
SHEET: L2	APPROVED BY: AWH
	PLOT DATE: Nov/8/2024

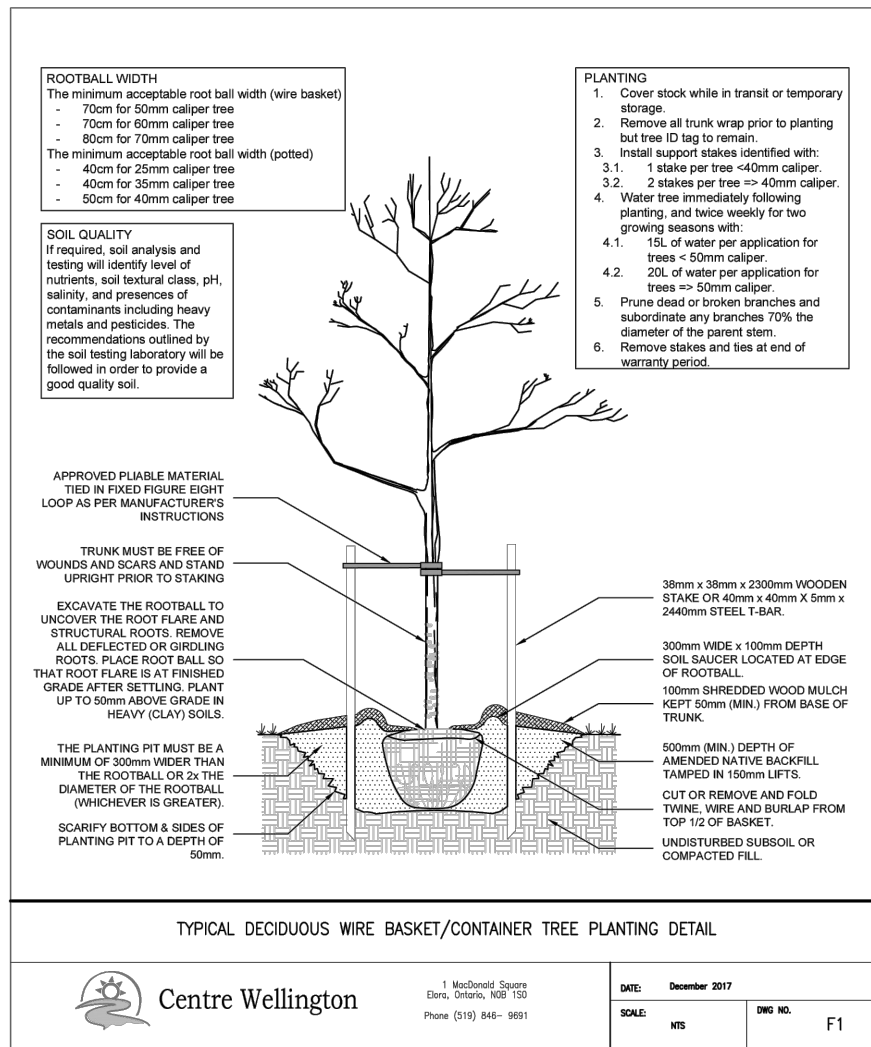

1 CENTRE WELLINGTON STANDARD DECIDUOUS TREE PLANTING DETAIL  
NTS

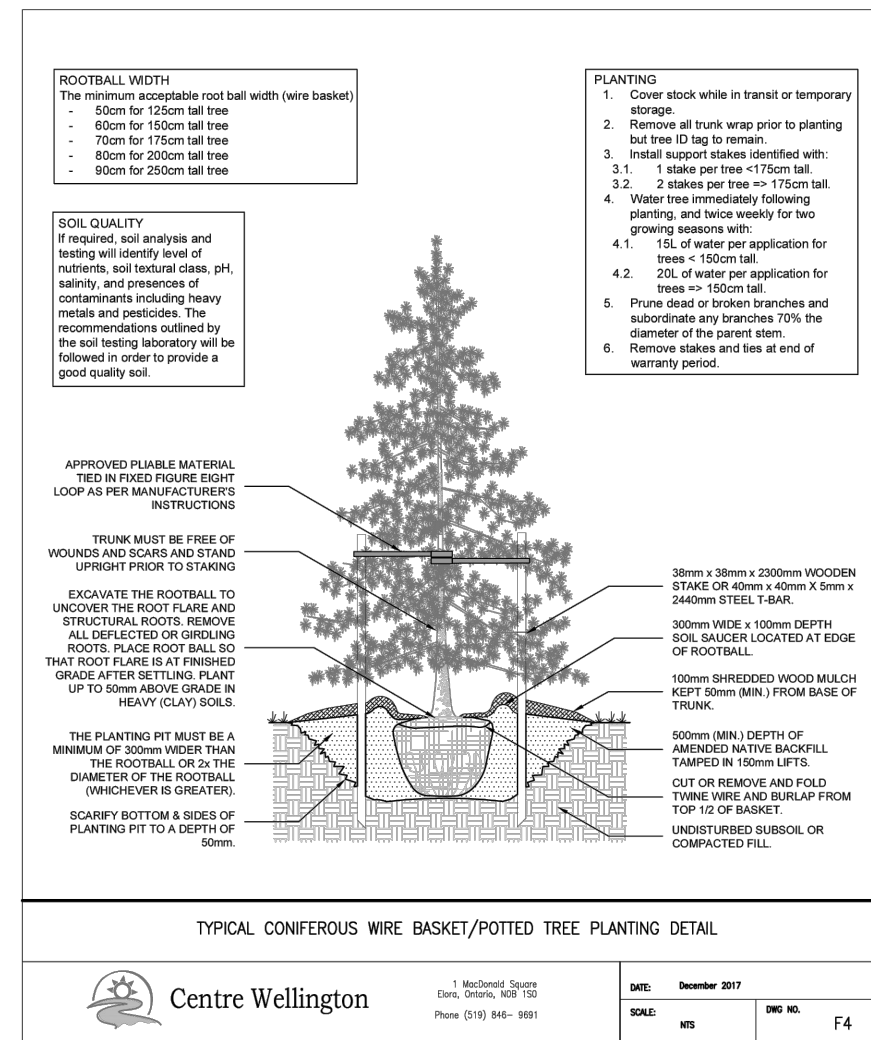

2 CENTRE WELLINGTON STANDARD CONIFEROUS TREE PLANTING DETAIL  
NTS

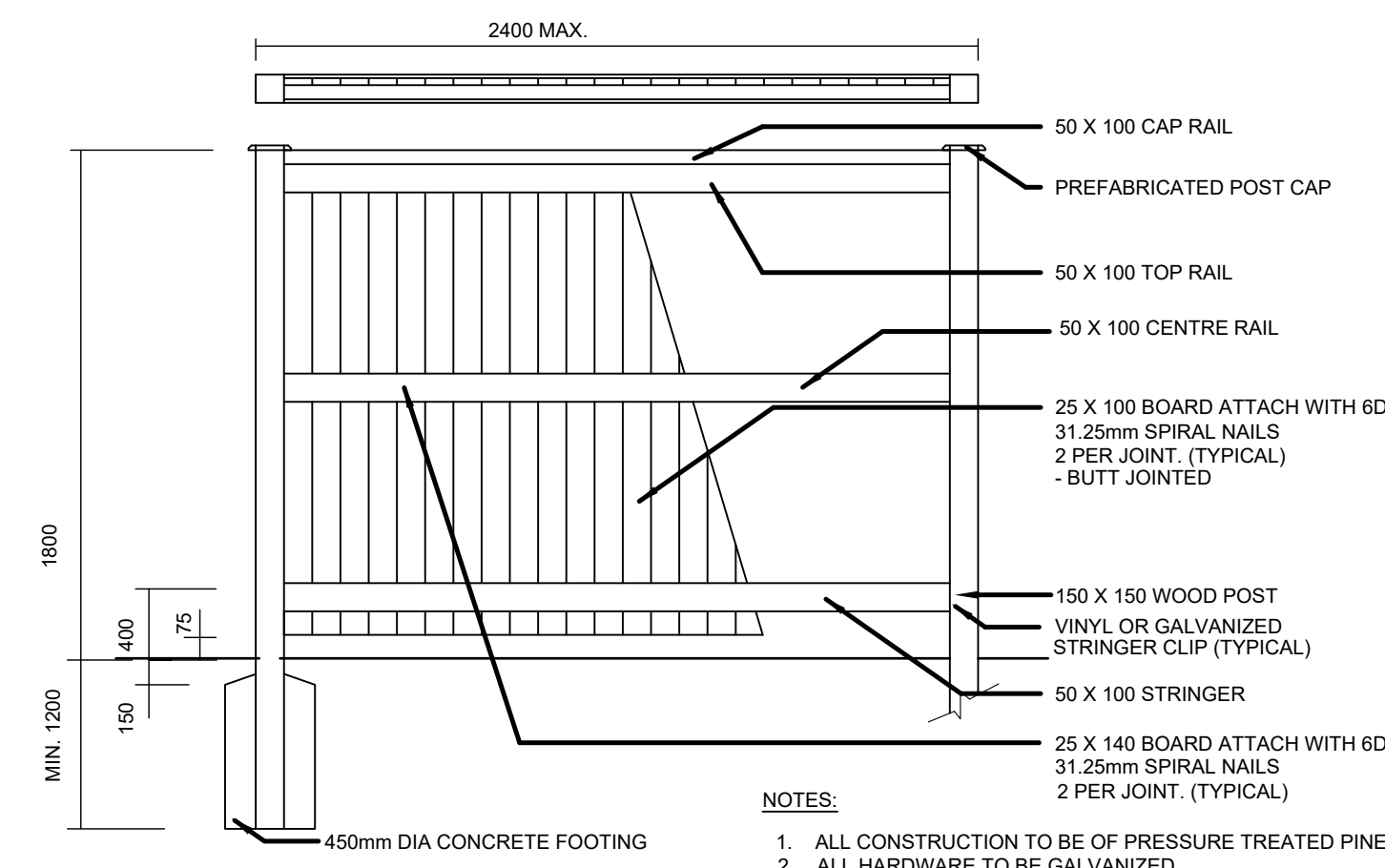

3 1.8m HIGH PRIVACY FENCE DETAIL  
NTS

BENCH BY MAGLIN (OR APPROVED EQUAL)  
T 1-800-716-5506  
F 1-877-260-9393  
WWW.MAGLIN.COM  
SALES@MAGLIN.COM

SPECIFICATIONS:  
MODEL: MTB-0210-0094D  
MATERIAL: THERMALLY MODIFIED ASH WOOD  
POWDER COAT COLOUR: SILVER 14, FROM FINE TEXTURED COLLECTION (MATTE FINISH)  
OPTIONS: SURFACE MOUNT  
INSTALLATION: SURFACE MOUNT AS PER MANUFACTURER'S SPECIFICATIONS

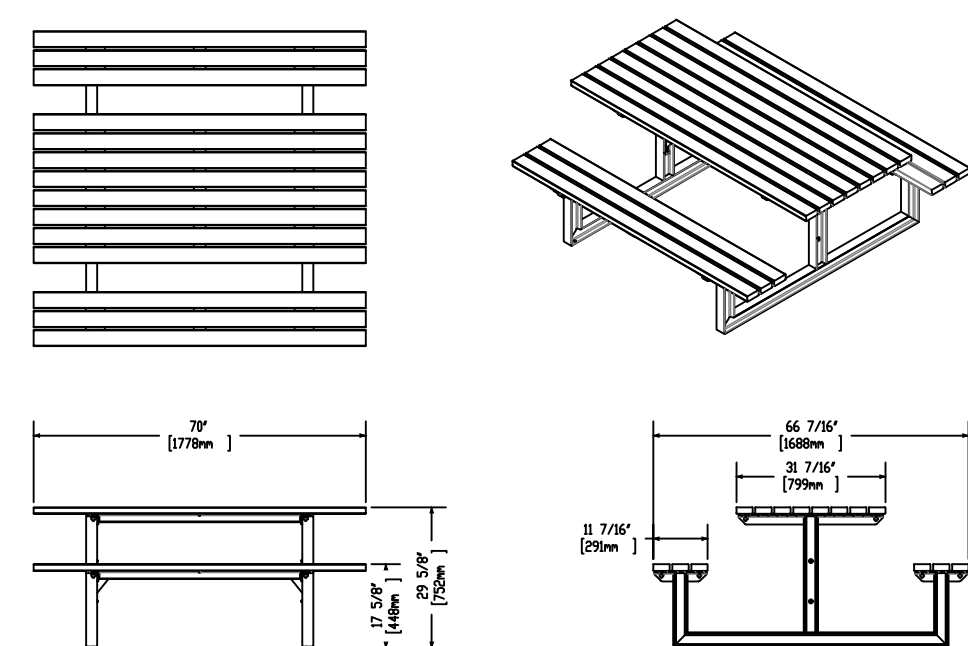

4 MAGLIN PICNIC TABLE  
NTS

BENCH BY MAGLIN (OR APPROVED EQUAL)  
T 1-800-716-5506  
F 1-877-260-9393  
WWW.MAGLIN.COM  
SALES@MAGLIN.COM

SPECIFICATIONS:  
MODEL: MBE-0450-00019  
MATERIAL: THERMALLY MODIFIED ASH WOOD  
POWDER COAT COLOUR: SILVER 14, FROM FINE TEXTURED COLLECTION (MATTE FINISH)  
ACCESSORIES: NONE  
INSTALLATION: SURFACE MOUNT AS PER MANUFACTURER'S SPECIFICATIONS

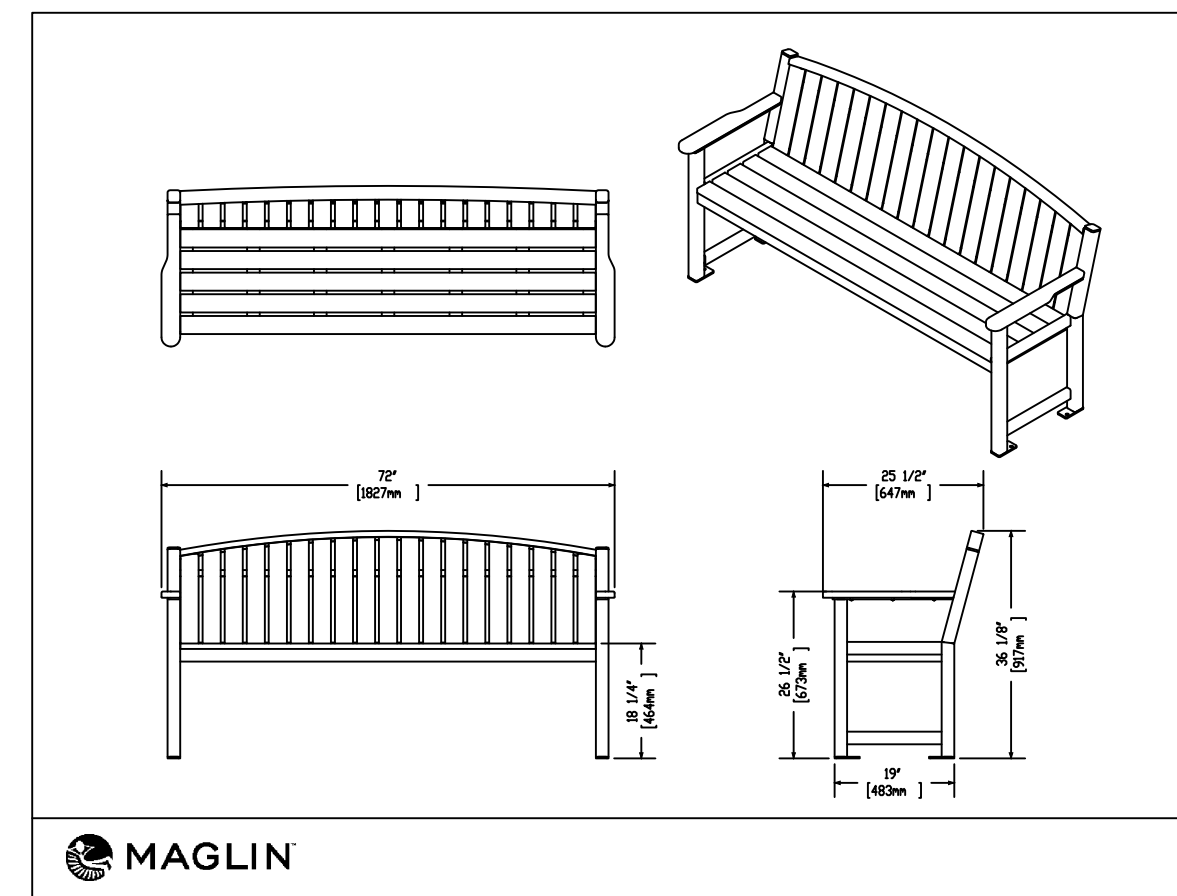

5 BENCH DETAIL  
NTS

PROVIDE SHOP DRAWING FOR REVIEW

GAZEBO BY COUNTRYSIDE GAZEBOS CANADA (OR APPROVED EQUAL)  
T 1-800-541-0612  
https://gazebo.com/

SPECIFICATIONS:  
SIZE: 4.6m  
STYLE: COUNTRY  
ROOF STYLE: PAGODA  
ROOFING: ASPHALT SHINGLES, CHARCOAL GREY  
MATERIAL: VINYL, WHITE  
INSTALLATION: AS PER MANUFACTURER'S SPECIFICATIONS  
FLOOR: NO FLOOR  
RAILINGS: NO RAILINGS



5 SHADE STRUCTURE  
NTS

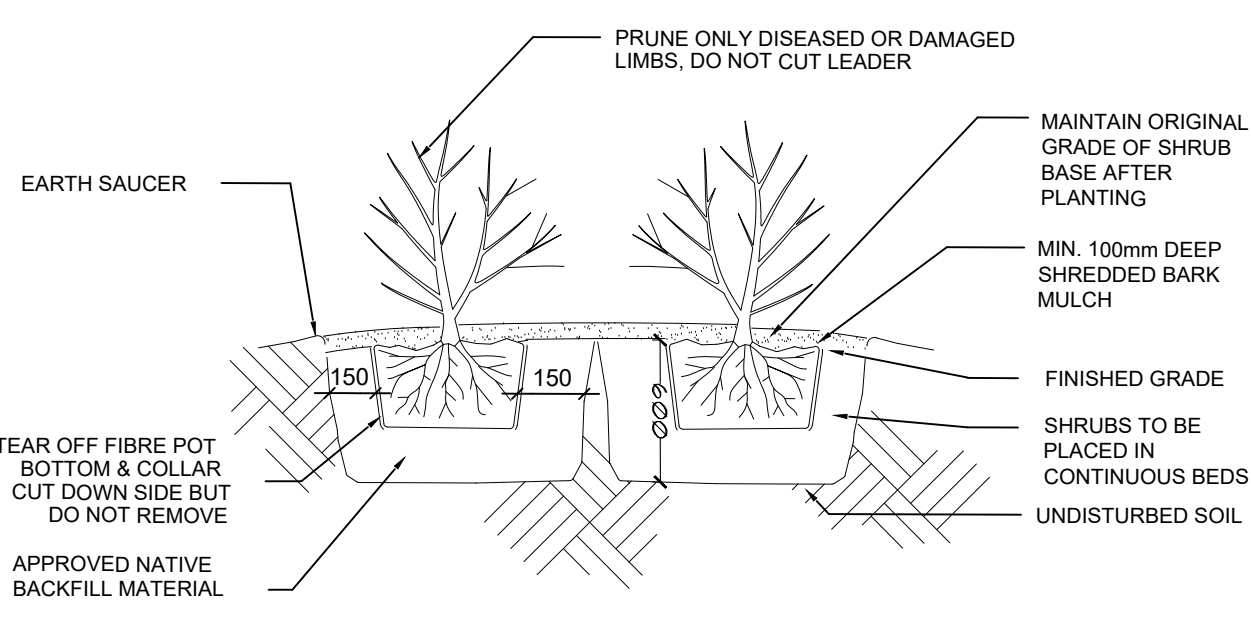

6 SHRUB PLANTING DETAIL  
NTS

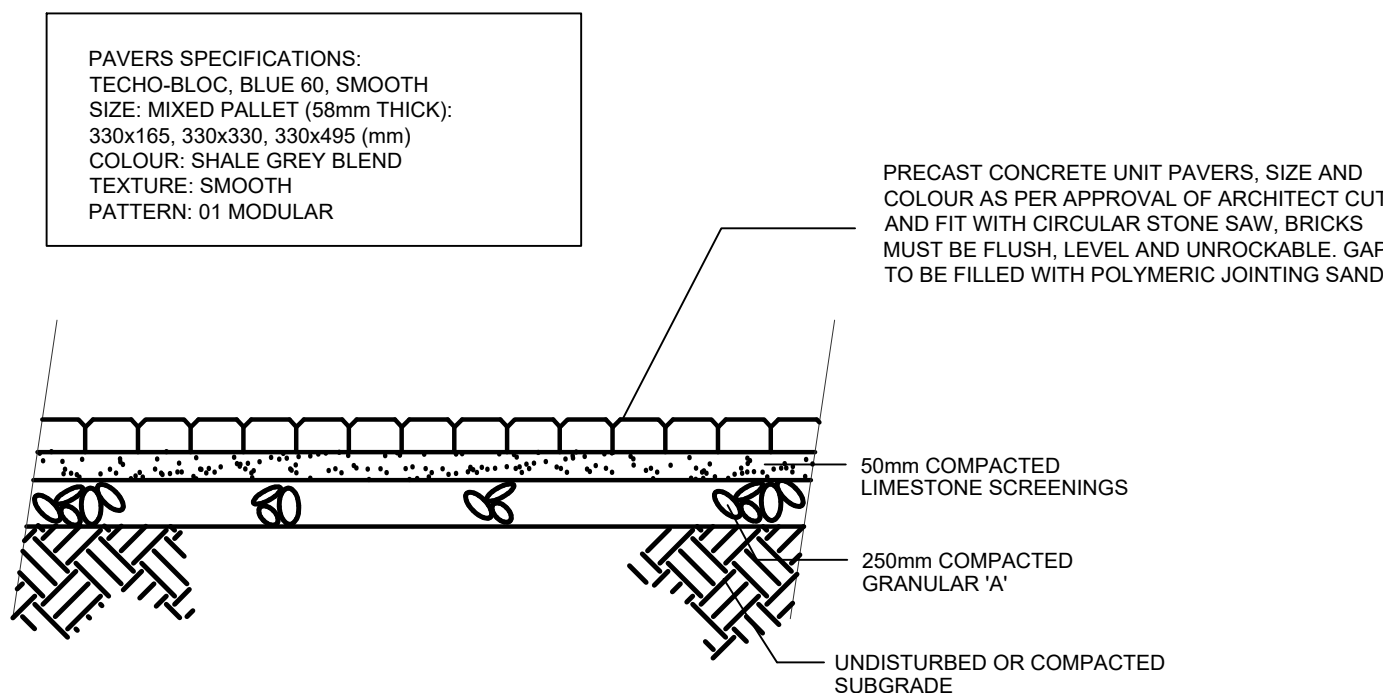

7 PRECAST UNIT PAVER DETAIL  
NTS

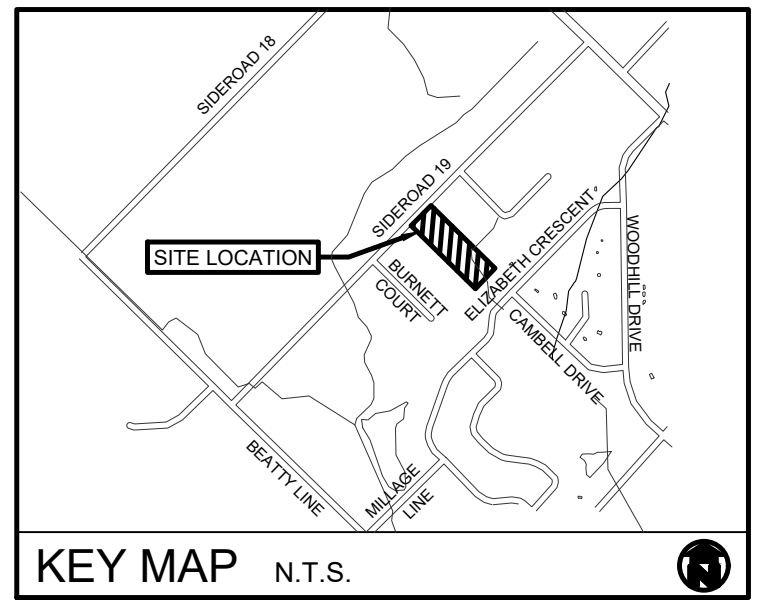

GENERAL NOTES

1. ALL CONSTRUCTION TO BE OF PRESSURE TREATED PINE.
2. ALL HARDWARE TO BE GALVANIZED.
3. ALL DIMENSIONS IN MILLIMETRES.
4. ALL PRESSURE TREATED CUTS TO BE DRESSED WITH COPPER NAPHTHATE.

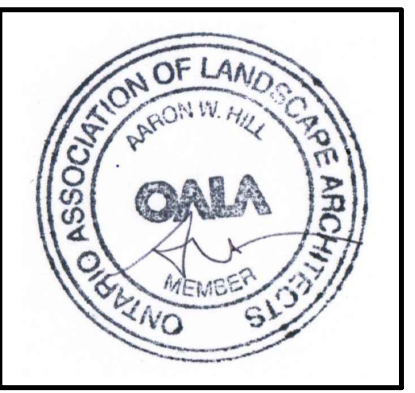

no.	date	description	by
1.	Nov. 8.2024	ISSUED FOR APPROVAL	JC

Wrightshaven Homes  
79 Sideroad 19  
Fergus

Details



PROJECT NO: 2024-75	DRAWN BY: JC
SCALE:	DESIGNED BY: JC
SHEET: L3	APPROVED BY: AWH
	PLOT DATE: Nov/8/2024